

# DDS Series

## Micro Mini Through-hole Detect Switches



### Specifications

<b>Contact Rating</b>	0.1A @ 30 VDC
<b>Mechanical/Electrical Life</b>	50,000 cycles min.
<b>Contact Resistance</b>	150 m $\Omega$ max. initial
<b>Insulation Resistance</b>	100 M $\Omega$ min. @ 100 VDC
<b>Operating Temperature</b>	-40°C to 85°C
<b>Dielectric Strength</b>	100 volts AC @ 60 Hz
<b>Packaging</b>	Bulk

### Ordering Number

Part number list is shown below. For individual part details, please refer to the following pages.

Part Number (Part Description)	Product Details
DDS001	Micro mini through-hole detect switches top actuated
DDS002	Micro mini through-hole detect switches side actuated right
DDS003	Micro mini through-hole detect switches side actuated left
DDS004	Micro mini SMT detect switches top actuated

### Description

DDS series micro mini thru-hole detect switches feature a low actuation force (less than 40g), a choice of vertical or horizontal actuation and a 2mm overtravel feature, making them ideal for detecting the presence of a mechanical device. Typically used in the medical device and consumer electronics industries, DDS switches are known for being long-lasting and compact.

### Features & Benefits

- Vertical or horizontal actuation
- 2mm overtravel—Ideal for detector applications
- Low actuations force (less than 40 grams)
- RoHS compliant and compatible

### Applications

- Detect the presence of a mechanical device
- Medical devices
- Consumer electronic devices

### Materials

<b>Housing</b>	P.P.S.
<b>Actuator</b>	PA66
<b>Movable Contact</b>	Tin bronze, silver plated

#### Notes

1. Specifications and materials listed above are for switches with standard options. For information on specific and custom switches, consult Customer Service Center.

# DDS Series

## Micro Mini Through-hole Detect Switches



### DDS001 SPST

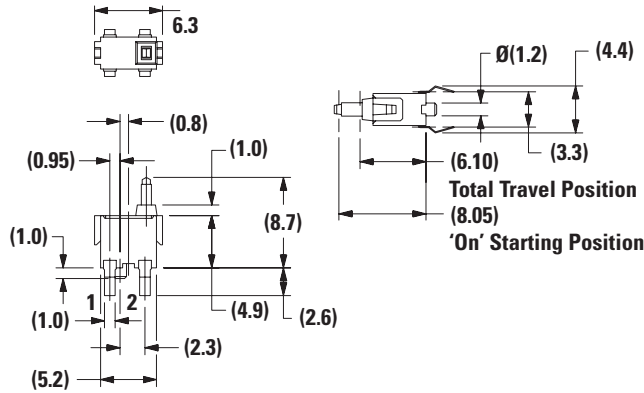

Note: Complete part numbers for DDS Series are shown above.

Part Number	Description	Schematic
DDS001	Vertical Actuator	

#### PC Mounting

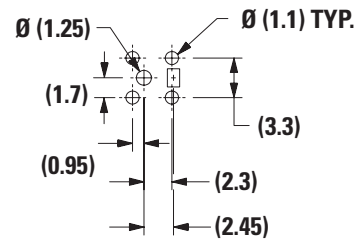

### DDS002 SPST

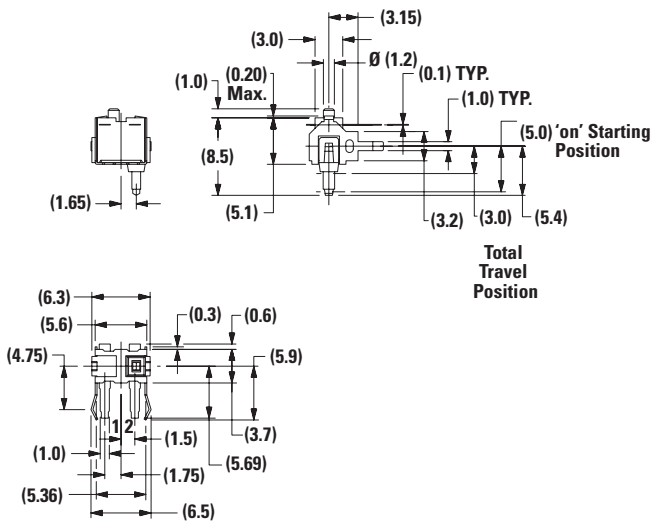

Part Number	Description	Schematic
DDS002	Right angle, actuator right	

#### PC Mounting

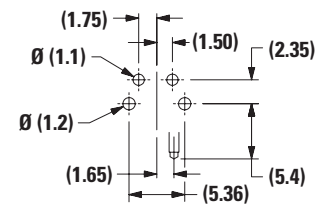

# DDS Series

## Micro Mini Through-hole Detect Switches



### DDS003 SPST

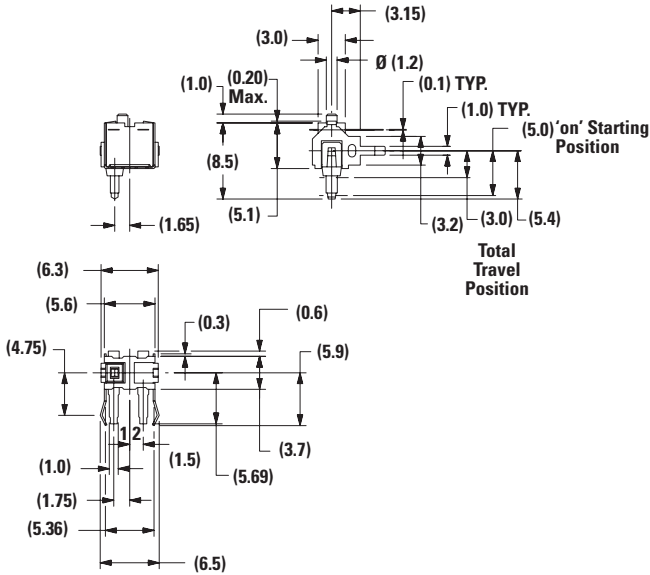

Part Number	Description	Schematic
DDS003	Right angle, actuator left	SPST N.O.

### PC Mounting

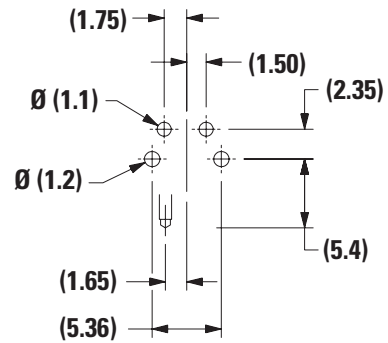

### DDS004 SPST

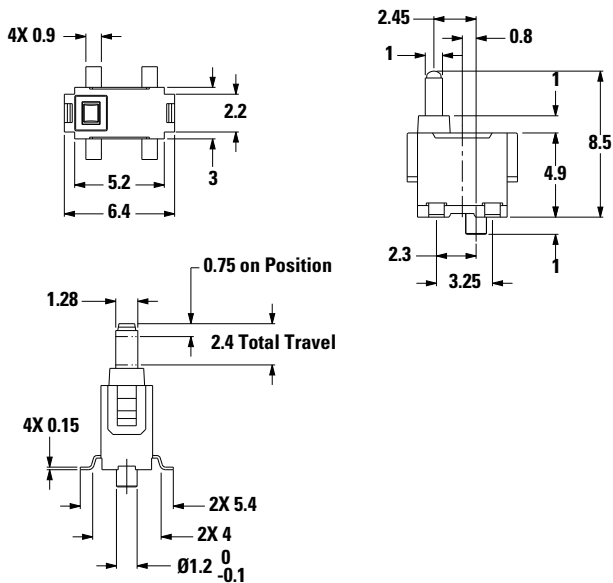

Part Number	Description	Schematic
DDS004	Vertical actuator	SPST N.O.

### PC Mounting

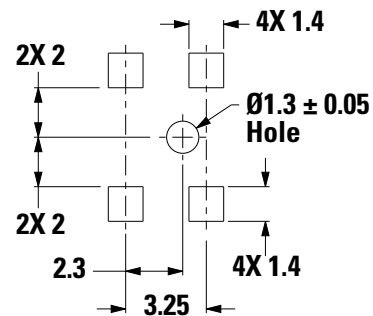

**Disclaimer Notice** - Information furnished is believed to be accurate and reliable. However, users should independently evaluate the suitability of and test each product selected for their own applications. Littelfuse products are not designed for, and may not be used in, all applications. Read complete Disclaimer Notice at <http://www.littelfuse.com/disclaimer-electronics>.