

ATP22 Series

Anti-Vandal Sealed Pushbutton Switch



Agency Approvals

Agency	Agency File Number
US	E42363

Specifications

Function	Single pole and double poles
Contact Arrangement	N.O. And N.C.
Mounting Type	Threaded front panel mount
Torque for Threaded Body	5-14 Nm

Mechanical Characteristics

Mechanical Life	Momentary 1,000,000 cycles Self-lock 500,000 cycles
Total Travel	About 3.2 mm
Operating Force	1 pole 2.5 ± 1N 2 pole 3.5 ± 1N

Electrical Characteristics

Contact Rating	1th 5A/250VAC 3A / 250VAC 3A / 28VDC
Operating Life	50,000 make-and-break cycles at full load
Dielectric Strength	2,000 V RMS @ sea level
Insulation Resistance	1,000 MΩ min. @ 500 VDC
Initial Contact Resistance	50 mΩ max @ 1A 12 VDC
Operating Temperature	-20°C to 55°C
Sealing / Protection	IP67 / IK10 (Stainless steel bushing)

Description

The ATP22 series is an anti-vandal sealed pushbutton switch offers the industry standard ring illuminated pushbutton in 22 mm diameter. The anti-vandal switches use a scratch resistant actuator and housings are made of robust stainless steel particularly suitable for use in equipment subjected to harsh conditions or applications that require protection from vandalism. The 22 mm pushbuttons meet the seal protection and impact resistance ratings of IP67 and IK10 that design to withstand the possible extreme outdoor environmental and may subject to abuse. Also, the ATP22 comes with a variety of LED colors and various of indicators on the actuator that meet your application needs.

Features & Benefits

- Momentary or Lock version
- IP67 sealed & IK10 (Stainless steel bushing)
- Capable of up to 3A resistive load
- 50,000 life cycle at full load
- Various colors of LED illuminate indicator
- Choices of pushbutton with symbol on spot, ring or power logo

Applications

- Control Panels including car park and traffic light
- Industrial Instruments
- Lifts / Escalator
- Communication equipment
- Alarm, safety and security systems

Materials

Bushing	Stainless steel
Base	PBT (UL 94 V-0), PC (UL 94 V-2)
Actuator	PC; Stainless steel / Aluminum alloy
Internal Assembly	POM / PA66
Spring	Steel
Sealing / O-ring	Silicone
Terminals	Brass, silver or gold flash plated
Contact	Brass, coin silver, silver or gold flash plated

Notes:

Specifications and materials listed above are for switches with standard options. For information on specific and custom switches, please contact Customer Service.

ATP22 Series

Anti-Vandal Sealed Pushbutton Switch



Ordering Number

To order, simply select desired option from each category and place in the appropriate box.

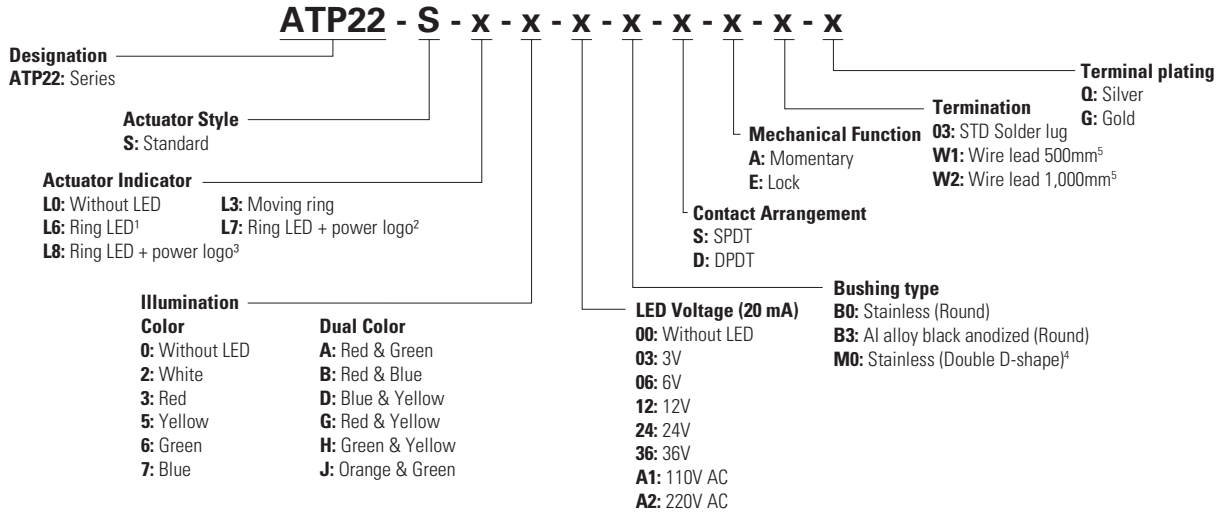

- Notes:**
1. Available on ring color CAP of red/green/blue only
 2. Power logo and ring with clear color CAP available on double D-shape bushing only
 3. Power logo and ring with red/green/blue color CAP available on double D-shape bushing only
 4. Not available on L0/L3/L6 actuator indicator
 5. Available upon request, please contact your sales representative for details

Standard View inches (mm)

Round Bushing

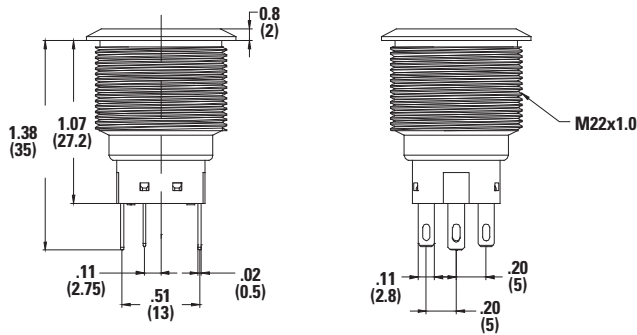

Double-D Bushing

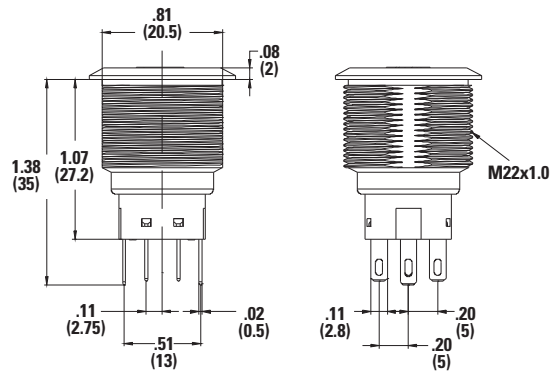

ATP22 Series

Anti-Vandal Sealed Pushbutton Switch



Actuator Style
S Standard

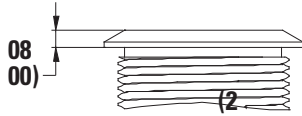

Actuator Indicator inches (mm)
L0 Without LED

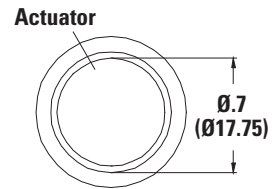

L3 & L6 Ring LED

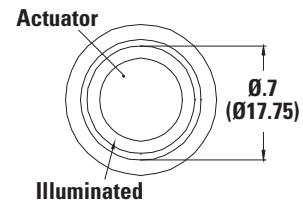

L7 & L8 Power & Ring

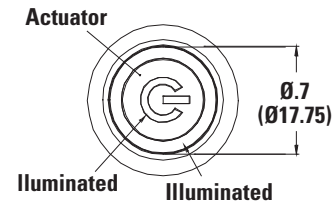

Circuit

SPST

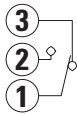

SPDT - Single Color LED

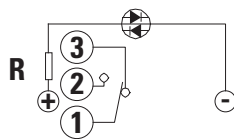

SPDT - Dual Color LED

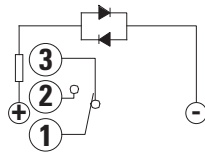

DPDT

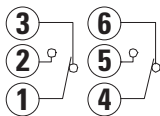

DPDT - Single Color LED

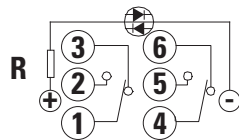

DPDT - Dual Color LED

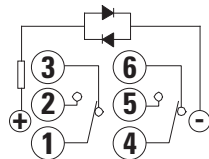

Termination inches (mm)

03 Solder Lug

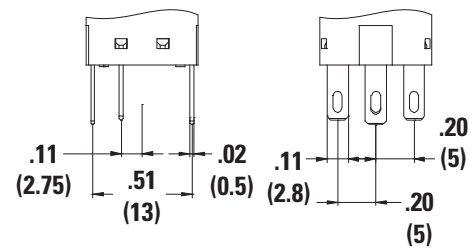

ATP22 Series

Anti-Vandal Sealed Pushbutton Switch



W1 or W2 Wire Lead

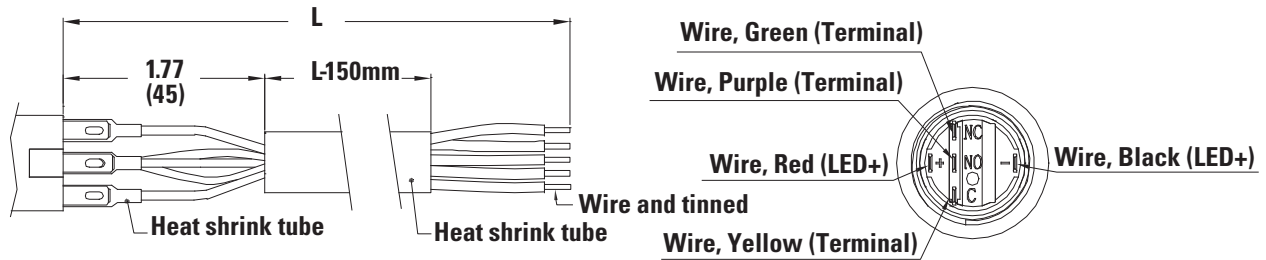

Hardware inches (mm)

Hex Nut
Order PN: ATP22-HN

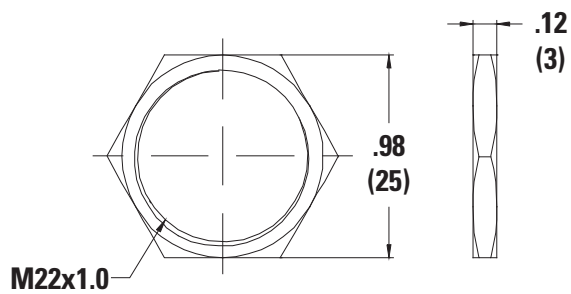

O Ring
Order PN: ATP22-OR

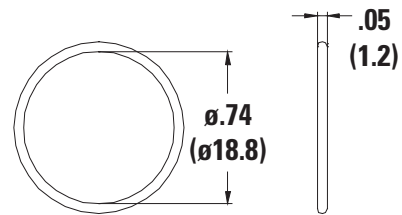

Disclaimer Notice - Information furnished is believed to be accurate and reliable. However, users should independently evaluate the suitability of and test each product selected for their own applications. Littelfuse products are not designed for, and may not be used in, all applications. Read complete Disclaimer Notice at <http://www.littelfuse.com/disclaimer-electronics>.