

DA Series

Miniature Single Pole Rocker Switches

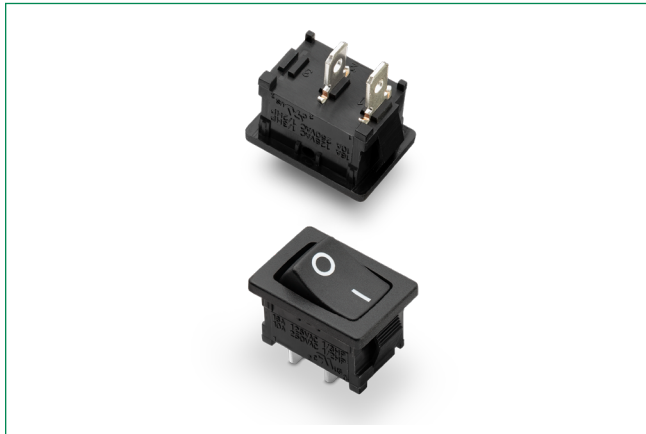

Description

Those designing medical instrumentation need to make sure that the components they use can withstand the harsh environments they're used in. The DA series miniature single pole rocker switches are perfect for that industry because of their IP54 splash proof rubber boot option and guards that prevent accidental actuation. Also used by makers of small appliances, computers and peripherals, the DA series also feature options for both momentary and maintained functions.

Features & Benefits

- Nice actuator styling with multiple options
- Guards to prevent accidental actuation
- Momentary and maintained functions
- IP54 splash proof rubber boot option
- RoHS compliant

Applications

- Small appliances
- Computers and peripherals
- Medical instrumentation

Agency Approvals

Agency	Agency File Number
	E61760

Specifications

Contact Rating	16 amps @ 125 VAC, 1/3 HP; 10 amps @ 250 VAC, 1/2 HP. 10 amps @ 125 VAC, 6 amps @ 250 VAC.
Electrical Life	10,000 make-and-break cycles at full load.
Dielectric Strength	1,500 Vrms min. @ sea level.
Insulation Resistance	10 ⁹ Ω min.
Operating Temperature	-20°C to 85°C

Notes:
Specifications and materials listed above are for switches with standard options. For information on specific and custom switches, consult Customer Service Center.

Materials

Actuator & Housing	6/6 nylon (UI 94V-2), black, matt finish
Illuminated Actuator	Polycarbonate, matte finish.
Center Contacts	Silver plated, copper alloy.
End Contacts	Silver plated.
All Terminals	Silver plated, copper alloy.

Ordering Number

To order, simply select desired option from each category and place in the appropriate box. For additional options not shown in catalog, consult Customer Service Center.

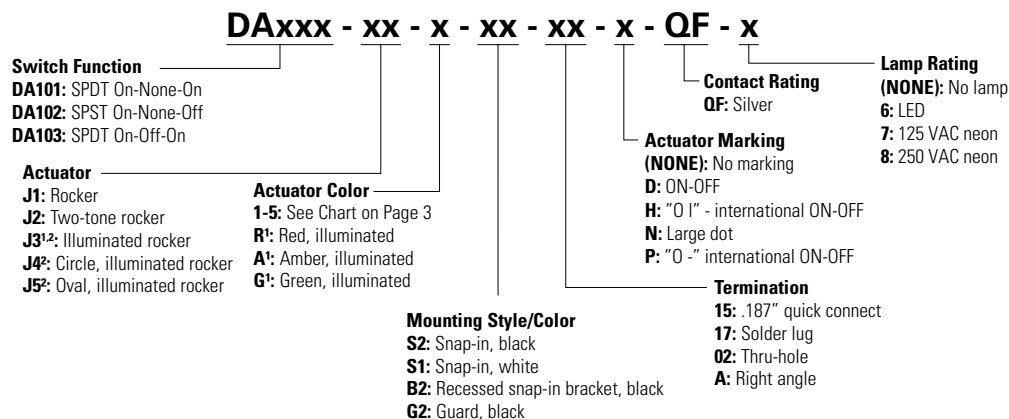

Notes:
1. Actuator "J3" illuminated switches are not available with actuator markings
2. Actuator "J3", "J4" and "J5" are not available with Termination option "17" solder lug

DA Series

Miniature Single Pole Rocker Switches



Switch Function SPDT

No. Poles	Model No.	Switch Function			Connected Terminals			Schematic
		POS.1	POS.2	POS.3	POS.1	POS.2	POS.3	
SP	DA101	ON	NONE	ON	2-1	N/A	2-3	
	DA103	ON	OFF	ON				
	DA102	ON	NONE	OFF	2-1	N/A	N/A	 For 7 & 8 Illuminated Versions Only For 6 Illuminated Versions Only

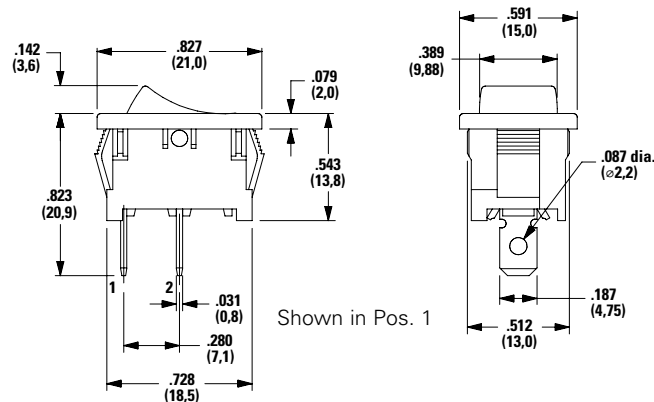

Actuator

J1 Rocker J3' Illuminated Rocker

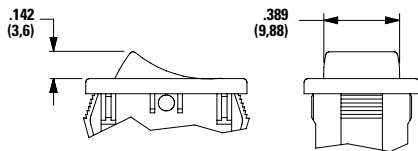

J2 Two-tone Rocker

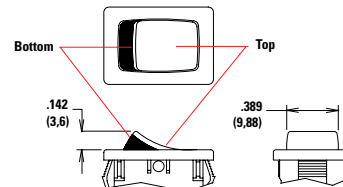

Notes: J3 actuator available with DA102 switch functions, 7&8 lamp ratings and not available with O2 and A termination options.
 1. J3 actuator not available with markings or Termination option "17" solder lug

Notes:
 1. Available with DA102 switch function only.
 2. Available with None or P actuator marking options only.

DA Series

Miniature Single Pole Rocker Switches



J4 Circle, Illuminated Rocker

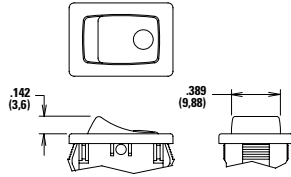

Notes: Available with DA102 switch function and 7 & 8 lamp ratings combinations only. Not available with O2 and A termination options.
1. J4 actuator not available with Termination option "17" solder lug

J5 Oval, Illuminated Rocker

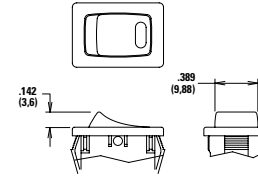

Notes: Available with DA102 switch function and 6 lamp rating combinations only. Not available with O2 and A termination options.
1. J5 actuator not available with Termination option "17" solder lug

Actuator Color

	Option Code	Actuator Color
J1 Only	2	Black
	1	White
	3	Red
J3, J4, J5 Only	R	Red, Illuminated
	A	Amber, Illuminated
	G	Green, Illuminated

	Option Code	Actuator Color	
		Top	Bottom
J2 Only	1	White	Red
	2	White	Black
	3	Red	White
	4	Black	White
	5	Black	Red

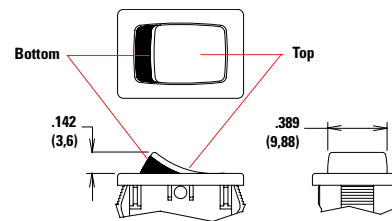

Mounting Style/Color

S2 Snap-in, Black S1 Snap-in, White

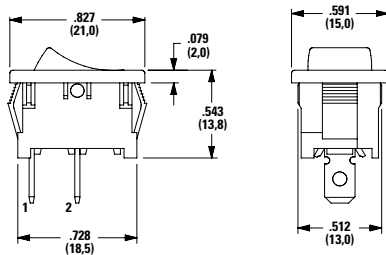

Actuator shown in Pos. 1

G2 Guard, Black

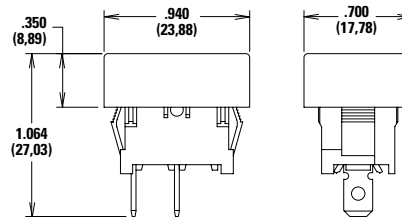

Notes: Available with DA10X switch functions only.

S2, S1 & G2 Panel Mounting

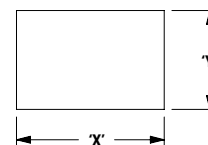

Panel Thickness	"X"	"Y"
0.030 - 0.049 (0.75-1.25)	0.756 - .004 (19.2-0.1)	0.512 + .004 (13.0+0.1)
0.049 - 0.079 (1.25-2.0)	0.764 - .004 (19.4-0.1)	0.512 + .004 (13.0+0.1)
0.079 - 0.118 (2.0-3.0)	0.779 - .004 (19.8-0.1)	0.512 + .004 (13.0+0.1)

DA Series

Miniature Single Pole Rocker Switches



B2 Recessed Snap-in Bracket, Black

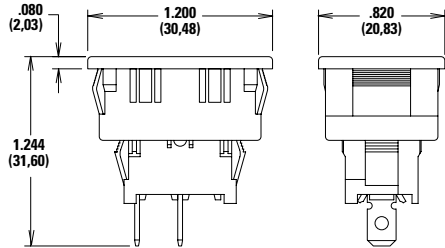

Notes: Available with DA10X switch functions only.

B2 Panel Mounting

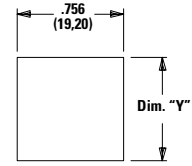

Panel Thickness	"Y"
0.030 - 0.049 (0.75-1.25)	1.068 (27.13)
0.049 - 0.079 (1.25-2.0)	1.076 (27.33)
0.079 - 0.118 (2.0-3.0)	1.092 (27.74)

Termination

15 0.187" Quick Connect

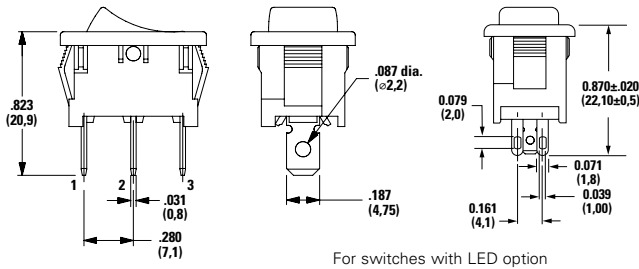

17 Solder Lug

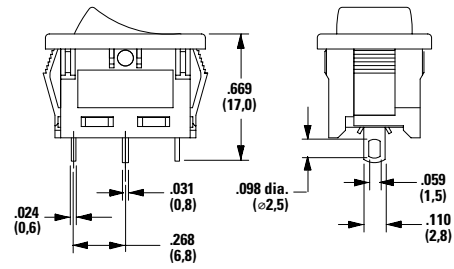

02' Thru-hole

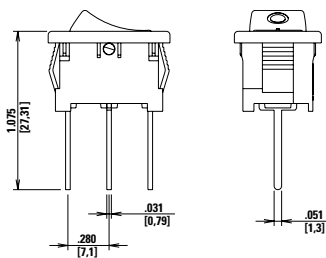

A1 Right Angle

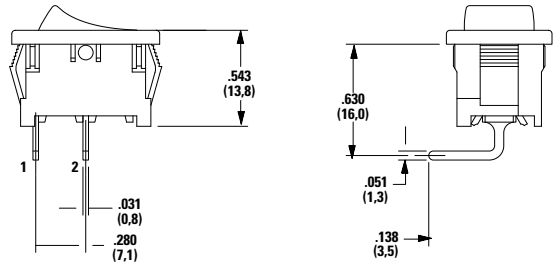

Notes:
1. 02 and A termination options not offered with J3, J4 or J5 actuator options.

Actuator Marking

None No Marking



D On-Off

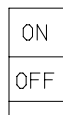

H - O I

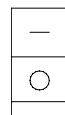

N Large Dot

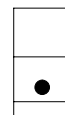

P - O -

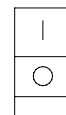

Notes: Orientation of actuator marking and terminals.
All models shown in Pos. 1
Markings not available with J3 actuator

DA Series

Miniature Single Pole Rocker Switches



Contact Material

Option Code	Contact Material	Ratings	
QF	Silver	Power	16 amps @ 125 VAC; 1/3 HP; 10 amps @ 250 VAC; ½ 10 amps @ 125 VAC, 6 amps @ 250 VAC

Notes: See Technical Data section of this catalog for RoHS compliant and compatible definitions and specifications.

Lamp Rating

- None:** No Lamp
- 6:** LED Rating @ 10 mA Vf=1.85V
- 7:** 125 VAC 33kΩ Neon
- 8:** 250 VAC 150kΩ Neon

Accessories

216C00000 IP54 Splash Proof Rubber Boot

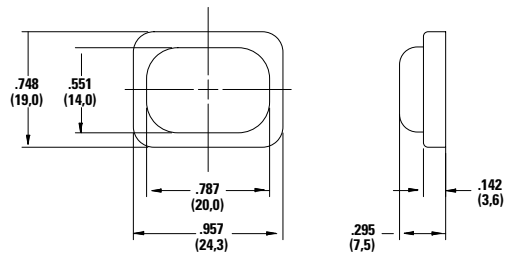

Disclaimer Notice - Information furnished is believed to be accurate and reliable. However, users should independently evaluate the suitability of and test each product selected for their own applications. Littelfuse products are not designed for, and may not be used in, all applications. Read complete Disclaimer Notice at <http://www.littelfuse.com/disclaimer-electronics>.