

YF Series

4 Tumbler Miniature Switchlocks



Description

The YF series 4 tumbler miniature switchlock is perfect for use in cash registers, point-of-sale terminals and server hardware. The high-quality YF series features multi-pole and multi-position options, positive detent and can operate at a low power level.

Features & Benefits

- Multi-pole and multi-position
- Positive detent
- Low level and power capability

Applications

- Computer servers
- Point-of-sale terminals
- Cash registers

Agency Approvals

Agency	Agency File Number
	E42363

Specifications

Contact Ratings	Q contact material: 4 amps @ 125 V AC or 28 V DC; 2 amps @ 250 V AC (UL). See page 3 for additional ratings.
Contact Resistance	Below 10 m Ω typ. initial @ 2-4 V DC, 100 mA, for both silver and gold plated contacts.

Electrical Characteristics

Electrical Life	10,000 make-and-break cycles at full load.
Insulation Resistance	10 ⁹ Ω min.
Dielectric Strength	1,000 Vrms min. @ sea level.
Indexing	90°: 2 positions max.

Materials

Lock	Zinc alloy with stainless steel facing. 4 tumbler, single bitted lock with integral detent mechanism.
Keys	Two nickel plated brass keys with code number.
Switch Housing	6/6 Nylon (UL 94 V-2).
Contacts and Terminals	Q contact material: Copper, silver plated. See page 3 for additional contact materials.
Mounting Nut	Brass, bright zinc plated.
Terminal Seal	Epoxy

Notes:

Any models supplied with Q or B contact material are RoHS compliant. Specifications and materials listed above are for switchlocks with standard options. For information on specific and custom switchlocks, consult Customer Service Center.

Ordering Number

To order, simply select desired option from each category and place in the appropriate box. For additional options not shown in catalog, consult Customer Service Center.

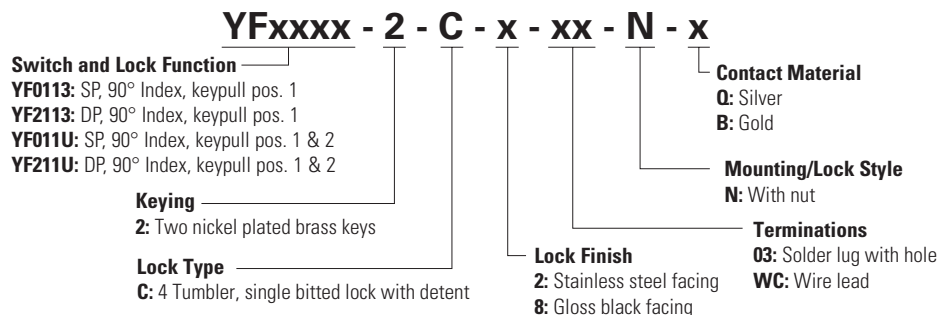

Notes: All models with all options when ordered with 'Q' contact material.

YF Series

4 Tumbler Miniature Switchlocks



Switch and Lock Function

Single & Double Pole Switches

No. Poles	Model No.	Connected Terminals			Key Pull Positions	Lock Configuration	Indexing
		POS. 1	POS. 2	POS. 3			
SP, DP	YF0113 YF2113	8-1	1-3, 1-3, 5-7	-	Position 1		90°
	YF011U YF211U	8-1, 4-5	1-3, 5-7	-	Position 1 & 2		

Notes: All models c us with all options when ordered with 'Q' contact material.

Legend

- = Detent Positions (45° or 90°)
- ⊙ = Key pull possible in these positions.
- ⊙ = Stop Positions

Terminal Numbers

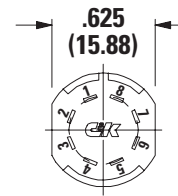

Notes: Terminal numbers molded on bottom of housing.

YF Series Dimensions - inches (mm)

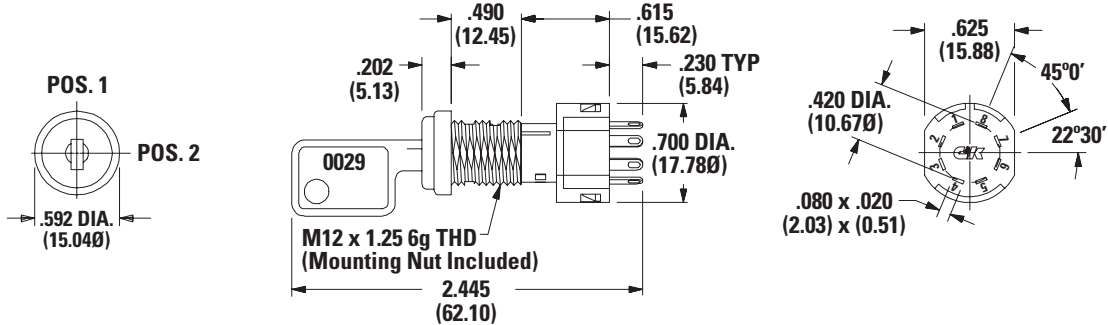

Notes: Terminal numbers molded on housing. Part number shown: YF01132C203NQ

Keying

2 Two Nickel Plated Brass Keys

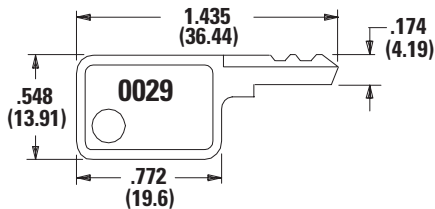

Note: All orders keyed alike with code number on key. For more than one key code, replacement keys, or other special features, consult Customer Service Center.

Key Part Number: 960B10029

Lock Type

C 4 Tumbler, Single Bitted Lock with Detent

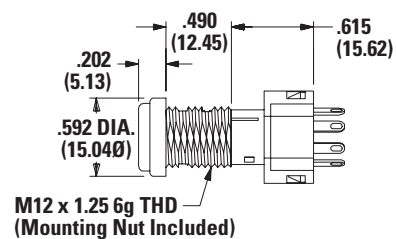

YF Series

4 Tumbler Miniature Switchlocks



Lock Finish

2 Stainless Steel Facing



8 Gloss Black Facing



Terminations

03 Solder Lug with Hole

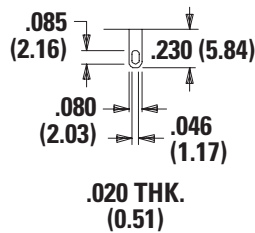

WC Wire Lead

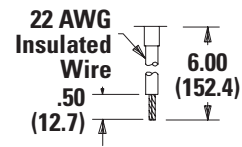

Note: Black wire standard, other colors and lengths available, consult Customer Service Center. UL style 1015.

Mounting Style

N with Nut

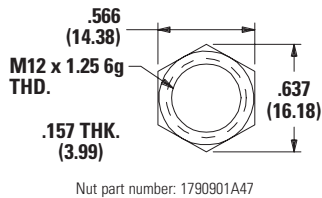

Panel Mounting

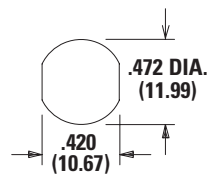

Panel Thickness:
.300 (7.62) max.

Switch and Lock Assembly Instructions

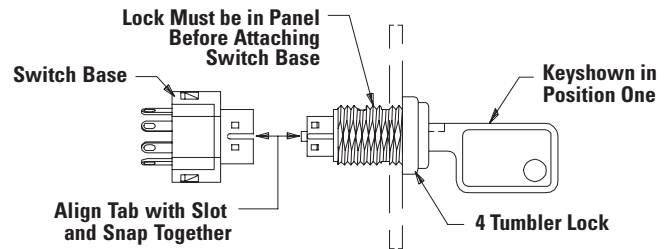

Note: Switch installation is permanent. Switch cannot be removed from lock after assembly. Attempts to separate switch and lock may damage switch.

YF Series

4 Tumbler Miniature Switchlocks



Contact Material

Option Code	ROHS Compliant ¹	ROHS Compatible ¹	Contact and Terminal Material	Rating	
Q	Yes	Yes	Silver ²	Power	4 amps @ 125 V AC or 28 V DC; 2 amps @ 250 V AC ³
B	Yes	Yes	Gold ¹	Low Level / Dry Circuit	0.4 VA max. @ 20 V AC or DC max.

Note: See Technical Data section of this catalog for RoHS compliant and compatible definitions and specifications.

1. Contacts & Terminals: Copper, with gold plate over nickel plate.

2. Contacts & Terminals: Copper, silver plated (std. with all termination options).

3. All models  with all options when ordered with 'G' or 'Q' contact material.

Available Hardware



Material: Brass

Finish: Nickel plate

Key Code: 0029

Part No. (One Key) 960B10029

Disclaimer Notice - Information furnished is believed to be accurate and reliable. However, users should independently evaluate the suitability of and test each product selected for their own applications. Littelfuse products are not designed for, and may not be used in, all applications. Read complete Disclaimer Notice at <http://www.littelfuse.com/disclaimer-electronics>.