

# YM Series

## 4 Tumbler Miniature Switchlocks



### Description

Designers of cable TV connectors, automotive accessories and computers turn to YM series of 4 tumbler miniature switchlocks to meet their security needs. As a 4 tumbler lock with positive detent, the YM series feature snap-together assemblies for pre-wiring the switch and are available with wire lead terminations.

### Features & Benefits

- Snap-together assembly allows for pre-wiring of switch
- Wire lead terminations available
- 4 Tumbler lock with positive detent

### Applications

- Cable TV connectors
- Automotive accessories
- Computers

### Specifications

<b>Contact Ratings</b>	Q contact material: 4 amps @ 125 V AC or 28 V DC; 2 amps @ 250 V AC (UL). 4 amps @ 125 V AC, 2 amps @ 250 V AC, T65, class 1 (VDE). See page 3 for additional ratings.
<b>Contact Resistance</b>	Below 10 m Ω typ. initial @ 2-4 V DC, 100 mA

### Electrical Characteristics

<b>Electrical Life</b>	10,000 make-and-break cycles at full load.
<b>Insulation Resistance</b>	10 <sup>9</sup> Ω min.
<b>Dielectric Strength</b>	1,000 Vrms min. @ sea level.
<b>Indexing</b>	90°: 2 positions

**Notes:**  
Max temperature for UL Recognition is 65°C.

### Agency Approvals

Agency	Agency File Number
	E42363

### Materials

<b>Lock</b>	Zinc alloy with stainless steel facing. 4 tumbler single bitted lock with integral detent mechanism.
<b>Keys</b>	Two nickel plated brass keys with code number.
<b>Switch Housing</b>	6/6 Nylon (UL 94 V-2).
<b>Contacts and Terminals</b>	Q contact material: Copper, silver plated. See page 3 for additional contact materials
<b>Mounting Nut</b>	Brass, bright zinc plated.

**Notes:**  
Any models supplied with Q or B contact material are RoHS compliant. Specifications and materials listed above are for switchlocks with standard options. For information on specific and custom switchlocks, consult Customer Service Center.

### Ordering Number

To order, simply select desired option from each category and place in the appropriate box. For additional options not shown in catalog, consult Customer Service Center.

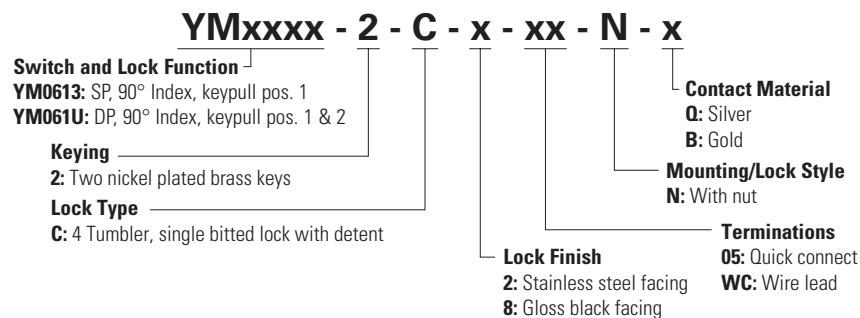

# YM Series

## 4 Tumbler Miniature Switchlocks



### Switch and Lock Function

No. Poles	Model No.	Switch Function		Key Pull Positions	Lock Configuration	Indexing	Schematic
		POS. 1	POS. 2				
SP	YM0613	OFF	ON	Position 1		90°	
SP	YM061U	OFF	ON	Position 1 & 2			

### SPST inches (mm)

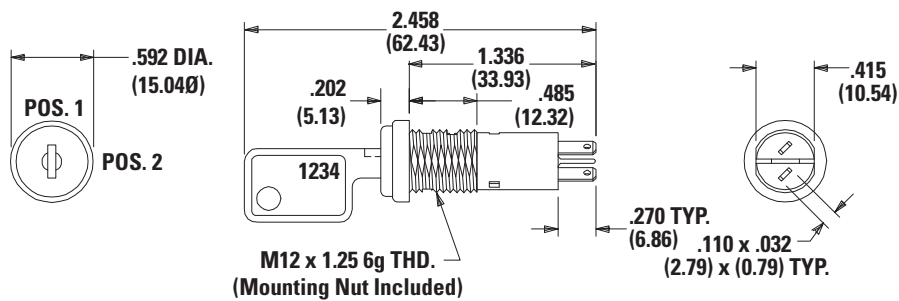

Part number shown: YM0613C205NQ

Notes: All models us with all options when ordered with 'Q' contact material.

#### Legend

- = Detent Positions (90°)
- ⊙ = Key pull possible in these positions
- ⊙ = Stop Positions

### Keying

#### 2 Two Nickel Plated Brass Keys

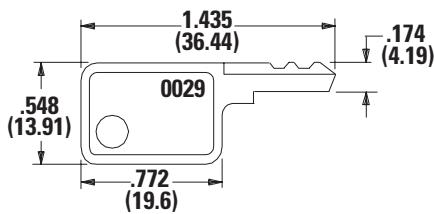

Key Part Number: 960B10029

Note: All orders keyed alike with code number on key. For more than one key code, replacement keys, or other special features, consult Customer Service Center.

### Lock Type

#### C 4 Tumbler, Single Bitted Lock with Detent

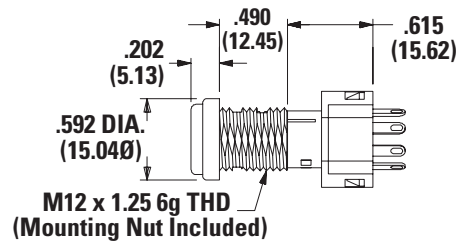

### Lock Finish

#### 2 Stainless Steel Facing



#### 8 Gloss Black Facing



# YM Series

## 4 Tumbler Miniature Switchlocks



### Terminations

#### 05 Quick Connect

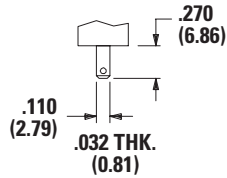

#### WC Wire Lead

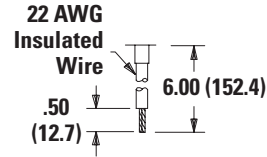

Black wire standard, other colors and lengths available, consult Customer Service Center. UL style 1015.

### Mounting Style

#### N With Nut

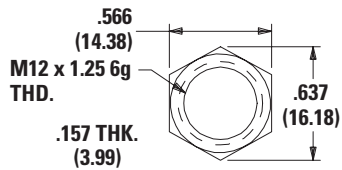

Nut part number: 1790901A47

#### Panel Mounting

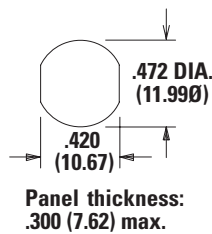

### Contact Material

Option Code	ROHS Compliant <sup>1</sup>	ROHS Compatible <sup>1</sup>	Contact and Terminal Material	Rating
Q	Yes	Yes	Silver <sup>2</sup>	Power 4 amps @ 125 V AC or 28 V DC; 2 amps @ 250 AC V AC (UL <sup>3</sup> ).
B	Yes	Yes	Gold <sup>1</sup>	Low Level / Dry Circuit 0.4 VA max. @ 20 V AC or DC max.

**Note:** See Technical Data section of this catalog for RoHS compliant and compatible definitions and specifications.

**1. Contacts & Terminals:** Copper, with gold plate over nickel plate.

**2. Contacts & Terminals:** Copper, silver plated (std. with all termination options).

**3.** All models **c** **RU** **US** with all options when ordered with 'G' or 'Q' contact material.

### Available Hardware



**Material:** Brass  
**Finish:** Nickel plate  
**Key Code:** 0029  
**Part No.** (One Key) 960B10029

**Disclaimer Notice** - Information furnished is believed to be accurate and reliable. However, users should independently evaluate the suitability of and test each product selected for their own applications. Littelfuse products are not designed for, and may not be used in, all applications. Read complete Disclaimer Notice at <http://www.littelfuse.com/disclaimer-electronics>.