

373 Series

TR5® Fuse, Fast Acting

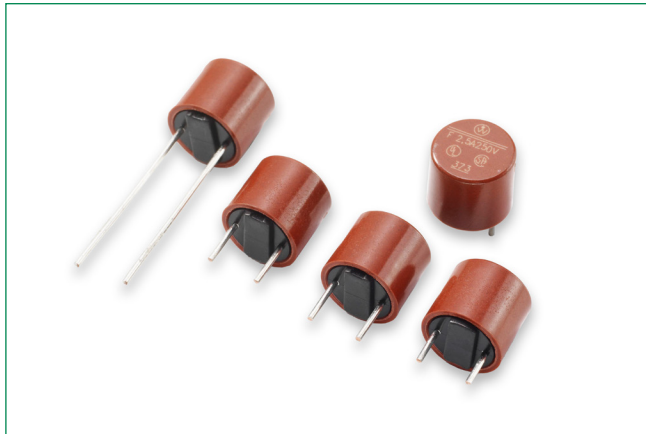

Description

The TR5® 373 Series fuses are fast-acting 250V rated and designed in accordance to UL 248 -14.

Features & Benefits

- Reduced PCB space requirements
- Direct solderable or plug-in versions
- Internationally approved
- Low internal resistance
- Shock safe casing
- Vibration resistant
- Lead-free, Halogen free and RoHS compliant
- Available from 0.050A to 10A

Additional Information



Resources



Accessories



Samples

Electrical Characteristics

| % of Ampere Rating | Ampere Rating | Opening Time |
|--------------------|---------------|-------------------------|
| 200% | 50mA - 6.3A | 5 Seconds, Max. |
| | 8A - 10A | 60 Seconds, Max. |

Applications

- Battery Chargers
- Consumer Electronics
- Power supplies
- Industrial Controllers

Agency Approvals

| Agency | Agency File Number | Ampere Range |
|--------|--------------------|---------------|
| | 51378 | 0.050A - 6.3A |
| | E67006 | 0.050A - 10A |
| | NA | 50mA - 10A |

Electrical Characteristics

| Amp Code | Rated Current | Voltage Rating | Breaking Capacity | Nominal Cold Resistance (Ohms) | Voltage Drop 1.0xI _N max. (mV) | Power Dissipation 1.0xI _N max. (mW) | Melting Integral 10xI _N max. (A ² s) | Agency Approvals | | |
|----------|---------------------|----------------|-------------------|--------------------------------|---|--|--|------------------|---|---|
| | | | | | | | | | | |
| 0050 | 50mA | 250V | 50A@250VAC | 7.6250 | 1400 | 70 | 0.0001 | X | X | X |
| 0063 | 63mA | 250V | | 4.6900 | 1300 | 85 | 0.0002 | X | X | X |
| 0080 | 80mA | 250V | | 3.6500 | 1200 | 100 | 0.0004 | X | X | X |
| 0100 | 100mA | 250V | | 8.9000 | 1100 | 110 | 0.0013 | X | X | X |
| 0125 | 125mA | 250V | | 6.0550 | 1000 | 125 | 0.0019 | X | X | X |
| 0160 | 160mA | 250V | | 4.1310 | 950 | 155 | 0.0040 | X | X | X |
| 0200 | 200mA | 250V | | 3.2260 | 850 | 170 | 0.0065 | X | X | X |
| 0250 | 250mA | 250V | | 2.2240 | 750 | 190 | 0.0140 | X | X | X |
| 0315 | 315mA | 250V | | 1.5150 | 650 | 205 | 0.0320 | X | X | X |
| 0400 | 400mA | 250V | | 0.2200 | 230 | 95 | 0.0160 | X | X | X |
| 0500 | 500mA | 250V | | 0.1570 | 220 | 110 | 0.0250 | X | X | X |
| 0630 | 630mA | 250V | | 0.1180 | 210 | 135 | 0.0450 | X | X | X |
| 0800 | 800mA | 250V | | 0.0970 | 200 | 160 | 0.0690 | X | X | X |
| 1100 | 1.00A | 250V | | 0.0710 | 190 | 190 | 0.1250 | X | X | X |
| 1125 | 1.25A | 250V | | 0.0665 | 180 | 225 | 0.2000 | X | X | X |
| 1160 | 1.60A | 250V | | 0.0480 | 170 | 275 | 0.3800 | X | X | X |
| 1200 | 2.00A | 250V | | 0.0359 | 160 | 320 | 0.6300 | X | X | X |
| 1250 | 2.50A | 250V | | 0.0305 | 150 | 375 | 1.2000 | X | X | X |
| 1315 | 3.15A | 250V | | 0.0240 | 140 | 445 | 1.9000 | X | X | X |
| 1400 | 4.00A | 250V | | 0.0185 | 130 | 520 | 3.5000 | X | X | X |
| 1500 | 5.00A | 250V | 0.0144 | 120 | 630 | 6.2000 | X | X | X | |
| 1630 | 6.30A | 250V | 0.0133 | 115 | 1000 | 9.1000 | X | X | X | |
| 1800 | 8.00A ¹ | 250V | 0.0074 | 120 | 1600 | 30.0000 | - | X | X | |
| 2100 | 10.00A ¹ | 250V | 0.0059 | 110 | 2000 | 55.0000 | - | X | X | |

¹ Conducting path cross-section minimum ≥ 0.2mm²

Notes: 1) 1.00 means the number one with two decimal places, 1.000 means the number one thousand.

2) Resistance is measured at 10% of rated current, 25°C.

373 Series

TR5® Fuse, Fast Acting

Temperature Re-rating Curve

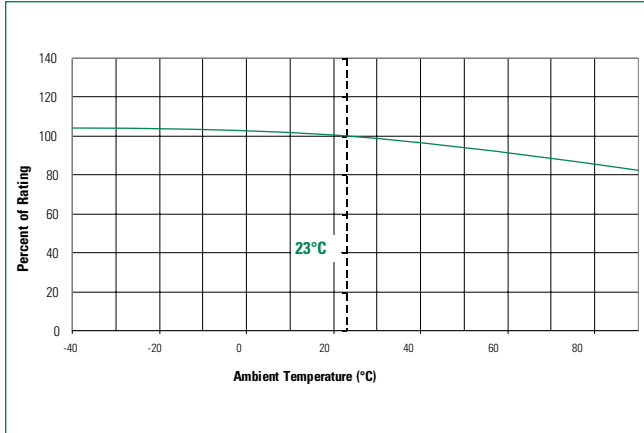

Note: 1. Rerating depicted in this curve is in addition to the standard derating of 25% for continuous operation.

Average Time Current Curves

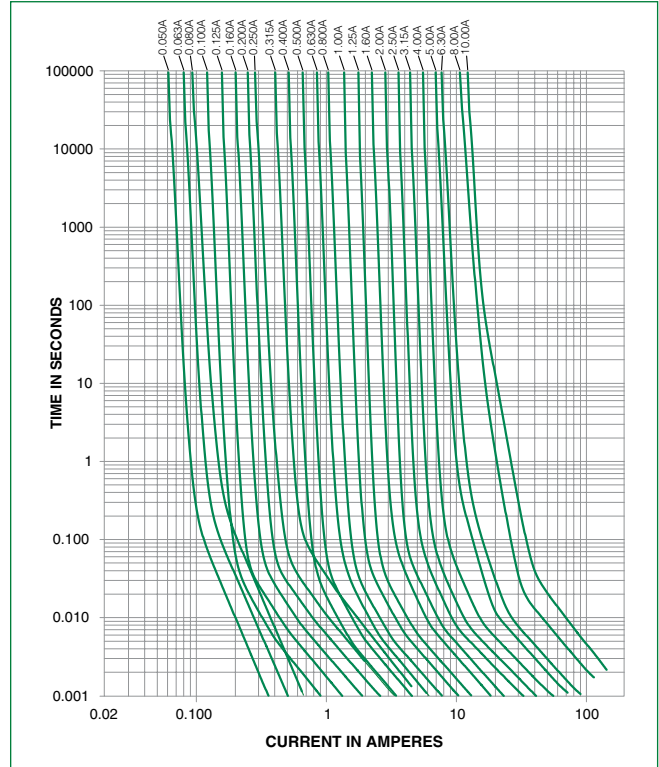

Soldering Parameters - Wave Soldering

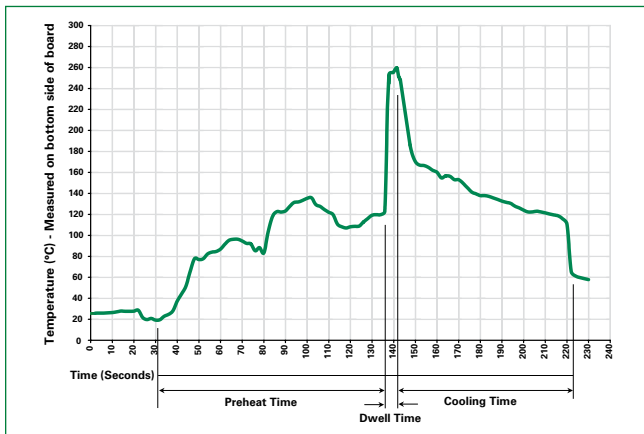

Recommended Process Parameters:

| Wave Parameter | Lead-Free Recommendation |
|--|-----------------------------------|
| Preheat: (Depends on Flux Activation Temperature) | (Typical Industry Recommendation) |
| Temperature Minimum: | 100°C |
| Temperature Maximum: | 150°C |
| Preheat Time: | 60-180 seconds |
| Solder Pot Temperature: | 260°C Maximum |
| Solder Dwell Time: | 2-5 seconds |

Recommended Hand-Solder Parameters:

Solder Iron Temperature: 350°C +/- 5°C
 Heating Time: 5 seconds max.

Note: These devices are not recommended for IR or Convection Reflow process.

373 Series

TR5® Fuse, Fast Acting

Product Characteristics

| | |
|----------------------------------|--|
| Materials | Base/Cap: Brown Thermoplastic Polyamide PA 6.6, UL 94 V-0 Round Pins: Copper, Tin-plated |
| Lead Pull Strength | 10 N (IEC 60068-2-21) |
| Solderability | 260°C, ≤ 3s. (Wave) 350°C, ≤ 1s. (Soldering Iron) |
| Soldering Heat Resistance | 260°C, 10s. (IEC 60068-2-20) 350°C, 3s. (Soldering Iron) |

| | |
|------------------------------|--|
| Operating Temperature | -40°C to +85°C (consider de-rating) |
| Climatic Category | -40°C/+85°C/21 days (EN 60068-1,-2-1,-2-2,-2-78) |
| Stock Conditions | +10°C to +60°C RH ≤ 75% yearly average, without dew, maximum value for 30 days-95% 24 cycles at 15 min. each (IEC 60068-2-6) |
| Vibration Resistance | 10 - 60 Hz at 0.75 mm amplitude 60 - 2000 Hz at 10G's acceleration |

Dimensions

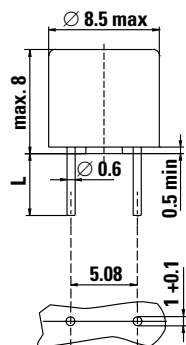

Holes in PCB

Long Leads (L=18.8mm ± 0.3 mm)

Short Leads (L=4.3mm ± 0.3 mm)

Part Numbering System

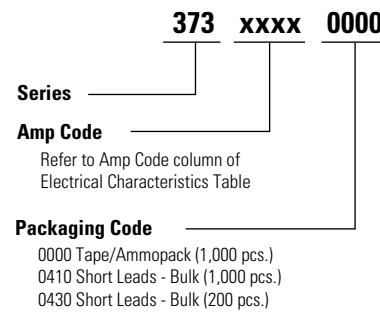

Packaging

| Packaging Option | Packaging Specification | Quantity | Quantity & Packaging Code | Taping Width |
|-------------------|-------------------------|----------|---------------------------|--------------|
| 373 Series | | | | |
| Tape & Ampopack | N/A | 1,000 | 0000 | N/A |
| Short Leads | N/A | 1,000 | 0410 | N/A |
| Short Leads | N/A | 200 | 0430 | N/A |

Disclaimer Notice - Information furnished is believed to be accurate and reliable. However, users should independently evaluate the suitability of and test each product selected for their own applications. Littelfuse products are not designed for, and may not be used in, all applications. Read complete Disclaimer Notice at: www.littelfuse.com/disclaimer-electronics.