

$\varnothing 20.6 \pm 0.18$   
 $[\varnothing 0.812 \pm 0.007]$

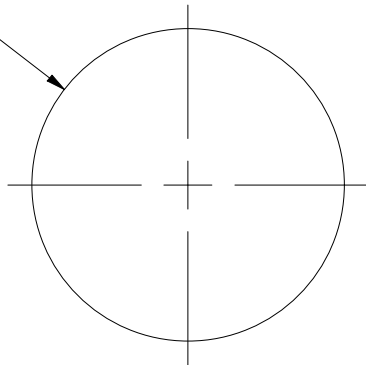

$50.8 \pm 0.79$   
 $[2.000 \pm 0.031]$

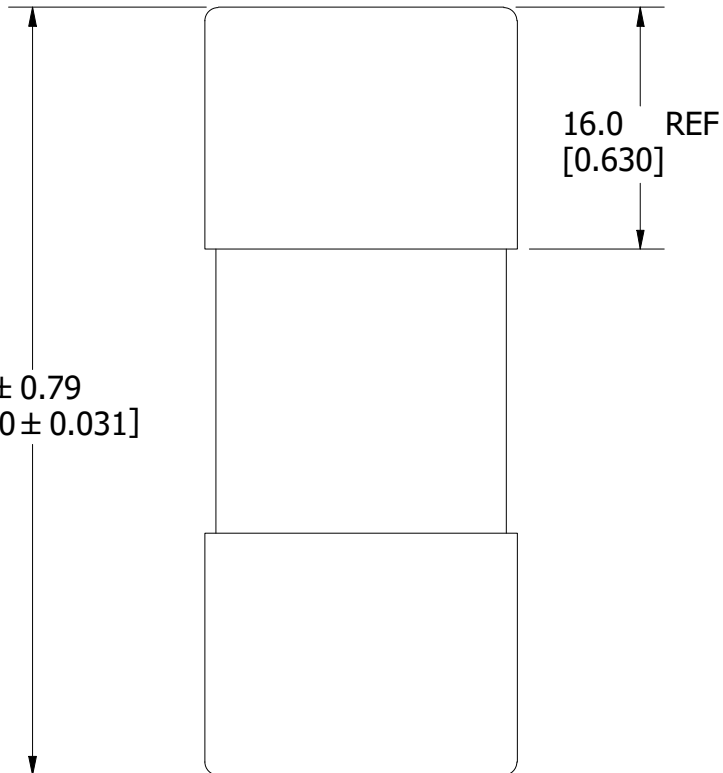

| REVISION |         |                         |
|----------|---------|-------------------------|
| REV      | DATE    | DESCRIPTION             |
| A        | 6/27/23 | 526651GCP - RELEASE MRY |

| 1   | NO   | COMPONENT NO | DESCRIPTION                   | QTY/M                  | U/M          |
|---|--|--------------|-------------------------------|------------------------|--------------|
| <b>BILL OF MATERIAL</b>   |  |              |                               |                        |              |
| <S>   | CRITICAL CHARACTERISTIC FOR PART SAFETY/COMPLIANCE   |              |                               |                        |              |
| ●   | DENOTES CRITICAL CHARACTERISTICS.  |              |                               |                        |              |
| CPK   | DENOTES CPK DIMENSIONS, -MINIMUM CPK VALUE   |              |                               |                        |              |
| ⊠   | DENOTES A CHARACTERISTIC THAT PROVIDES AN INDICATION OF PROCESS PERFORMANCE. PROCEDURE FOR MEASUREMENT AND TRACKING TO BE DEFINED IN LITTELFUSE INSPECTION INSTRUCTIONS. |              |                               |                        |              |
| CP  | DENOTES CP DIMENSIONS, -MINIMUM CP VALUE MUST BE WITHIN THE DIMENSIONAL LIMITATIONS SHOWN ON DRAWING AND INITIALLY LOCATED TO ALLOW FOR MAXIMUM TOOL LIFE.               |              |                               |                        |              |
| MATL SPEC   |  |              | FINISH                        |                        |              |
| DRW<br>JMoler   | DATE<br>6/19/2023  | SCALE<br>NTS | FINISH GOOD WT<br>GRAMS/PIECE |                        |              |
| UNLESS OTHERWISE SPECIFIED, DIMENSIONS ARE IN MILLIMETERS, DIMENSIONS IN BRACKETS [ ] ARE INCHES DIMENSIONING AND DO NOT INCLUDE PLATING. TOLERANCING TO BE INTERPRETED IN ACCORDANCE WITH ANSI Y14.5M-1994 |  |              |                               |                        |              |
| 3RD ANGLE<br>PROJECTION   |  |              |                               |                        |              |
| <b>TITLE</b> L15S 35-60A OUTLINE  |  |              |                               |                        |              |
| <b>Littelfuse</b><br>CHICAGO, ILLINOIS 60631  |  |              | REVISION<br>A                 | DRWG NO.<br>OL-L15S060 | SHEET 1 OF 1 |

**A**