

HSB Series

Bolt-down Fuses – Rated 32 V



Description

These fuses protect wires in diesel vehicles. Do not install the high-current automotive fuses in EVs or gasoline-fueled vehicles. Buy fuse holders separately.

Features & Benefits

- Ring-type lugs ensure secure mounting
- Zinc alloy elements and connectors
- Available with ratings of 30 A to 175 A
- Time- delayed

Applications

- Diesel vehicles

Agency Approvals

Agency	Agency File Number	Current Rating (A)
	20180817-E71611	30 – 175

[See Disclaimer Notice](#)

Additional Information



Resources



Samples

Specifications

Voltage Rating:	32 V DC
Interrupting Rating:	1000 A @ 32 V DC
Recommended Environmental Temperature:	-40 °C to +125 °C
Terminals Material:	Zinc Alloy
Torque Bolt M6:	4 Nm +/- 1 Nm

Ordering Information

Part Number	Package Size
156.5677.xxx1	100
156.5677.xxx2	10 000

HSB Series

Bolt-down Fuses – Rated 32 V

Ratings

Part Number	Current Rating (A)	Typ. Voltage Drop (mV)	Typ. Cold Resistance (mΩ)	Typ. I ² t (A ² s)	Material Thickness "S" (mm)
156.5677.530_	30	44	1.33	3800	0.4
156.5677.540_	40	40	0.89	11 200	0.4
156.5677.550_	50	44	0.72	21 300	0.4
156.5677.560_	60	38	0.58	41 400	0.4
156.5677.580_	80	40	0.43	44 800	0.8
156.5677.611_	110	40	0.31	139 000	0.8
156.5677.615_	150	52	0.23	465 000	0.8
156.5677.617_	175	46	0.22	560 000	0.8

Dimensions

Dimensions in mm. Please refer to the outline drawing for dimensions and tolerances.

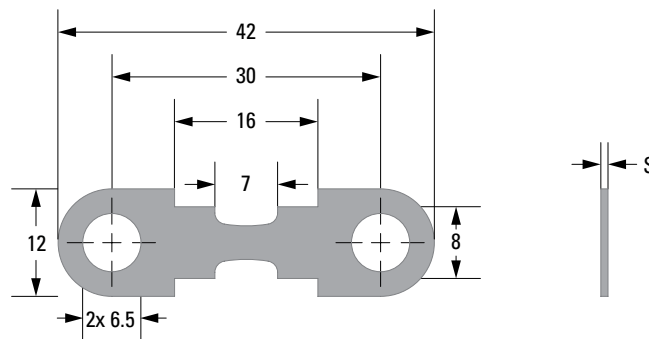

HSB Series

Bolt-down Fuses – Rated 32 V

Time-Current Characteristic

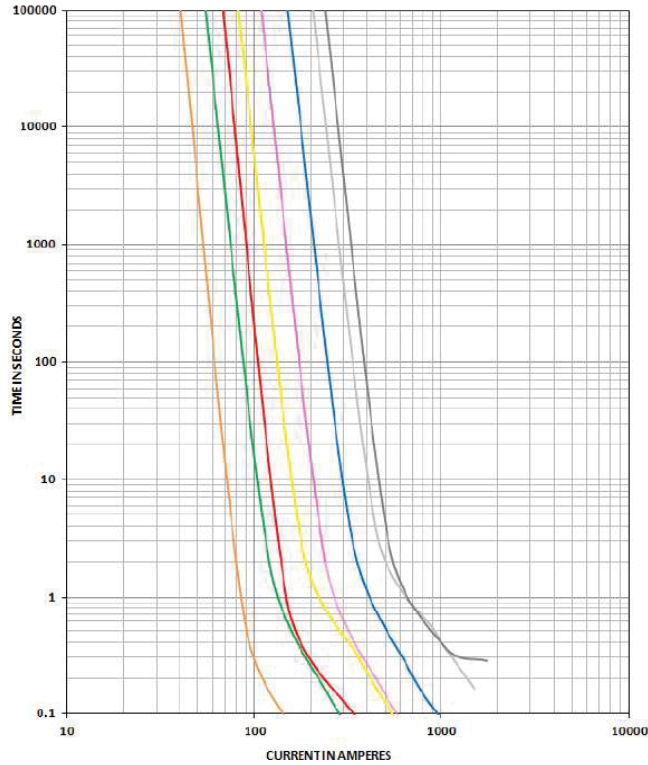

% of Rating	Opening Time Min. / Max. (s)
100	- / -
125	360 000 / -
300	0.100 / 10
600	0.020 / 1
1 000	0.010 / 0.300

- 30 A
- 40 A
- 50 A
- 60 A
- 80 A
- 110 A
- 150 A
- 175 A

Note 1: FI= 1.00 (max. operating current $1.0 \times I_{ra}$ at 23°C)

Note 2: Current recommendation may be impacted by the final condition of the application (terminals characteristics, wire size etc.). Please contact Littelfuse® for more information.

Disclaimer Notice - Information furnished is believed to be accurate and reliable. However, users should independently evaluate the suitability of and test each product selected for their own applications. Littelfuse products are not designed for, and may not be used in, all applications. Read complete Disclaimer Notice at <https://www.littelfuse.com/legal/disclaimers/product-disclaimer.aspx>