

SPFJ SERIES DC FUSE

1000 V dc • 70–450 A • Full Range • Solar-Rated



Description

The SPFJ series is the smallest 1000 V dc 70–450 A dc full range fuse available in the market. The SPFJ series is manufactured in Class J case sizes and is suitable for photovoltaic, dc cable protection, EV off-board charging and other dc applications that allow for both fuse holder and busbar mounting configurations. The SPFJ meets both UL and IEC requirements.

Features & Benefits

- Higher amperage capacity in standard sizes for more protection in a smaller space
- Full range over-current protection capability, suitable for dc cable protection
- Small footprint offers design flexibility and reduces panel size requirements
- Fuse holder or bus bar mountings available for added versatility

Applications

- Inverters
- Re-combiner boxes
- Dc cable protection
- EV off-board (dc fast) chargers

Recommended Fuse Holder

LFJ1000 Solar Series

Web Resources

Download technical documents: Littelfuse.com/SPFJ

Specifications

| | |
|-----------------------------|---|
| Voltage Rating | 1000 V dc 600 V ac (125–450 A) |
| Amperage Rating | 70–450 A |
| Interrupting Rating | Ac: 200 kAIC (125–450 A) Dc: 70–200 A: 20 kAIC 250–400 A: 10 kAIC 450 A: 20 kAIC |
| Time Constant | ≤ 1ms |
| Material | Body: Melamine End Bells: Copper Alloy |
| Approvals | cULus (File:E339112), VDE (Cert No. 40033659)** |
| Applicable Standards | UL 248-1, UL 248-8, UL 248-19, IEC 60269-6 |
| Environmental | RoHS Compliant |
| Country of Origin | Mexico |

Part Numbering System

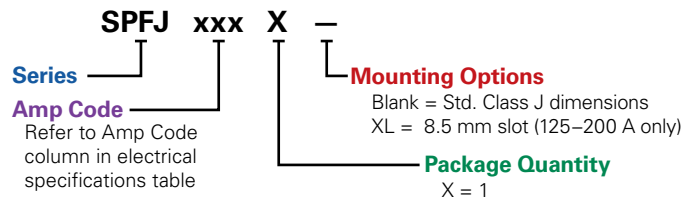

| SERIES | AMP | PACKAGE QUANTITY | CATALOG NUMBER | ORDERING NUMBER |
|--------|-----|------------------|----------------|-----------------|
| SPFJ | 70 | 1 | SPFJ070 | SPFJ070.X |
| SPFJ | 200 | 1 | SPFJ200 | SPFJ200.XXL |

Dimensions Inches (mm)

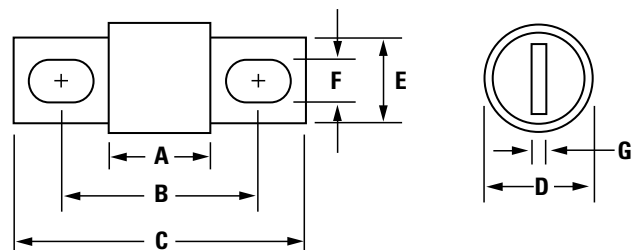

| AMPERAGE | DIMENSIONS IN INCHES (MM) | | | | | | |
|----------|---------------------------|--------------|---------------|------------|--------------|-------------|------------|
| | A | B | C | D | E | F | G |
| 70–100 | 3.02 (76.5) | 4.38 (111.3) | 5.75 (146.1) | 1.5 (38.1) | 1.125 (28.3) | .335 (8.5) | .189 (4.8) |
| 125–200 | 3.02 (76.5) | 4.38 (111.3) | 5.75 (146.1) | 1.5 (38.1) | 1.125 (28.3) | .281 (7.1)* | .189 (4.8) |
| 250–400 | 3.37 (85.7) | 5.25 (133.4) | 7.125 (181.0) | 2.0 (50.8) | 1.63 (41.3) | .406 (10.3) | .252 (6.4) |
| 450 | 3.75 (95.3) | 5.98 (152.0) | 8.0 (203.2) | 2.5 (63.5) | 2.0 (50.8) | .531 (13.5) | .374 (9.5) |

* SPFJ L option = .330 (8.5)
** Refer to Ordering Information table



Look for this logo to indicate products that are used in solar applications. Visit our website Littelfuse.com/Solar for the latest updates on approvals, certifications, and new products.

SPFJ SERIES DC FUSE

Ordering Information

| SERIES | AMPERAGE RATING | AMP CODE | CATALOG NUMBER | FUSE LABEL ID | ORDERING NUMBER | UPC CODE | cULus APPROVAL | | VDE APPROVAL |
|--------|-----------------|----------|----------------|---------------|-----------------|-------------|----------------|-----------|--------------|
| | | | | | | | 600 V AC | 1000 V DC | |
| SPFJ | 70 | 070. | SPFJ070 | SPFJ 70 | SPFJ070.X | 07945879326 | – | • | – |
| SPFJ | 80 | 080. | SPFJ080 | SPFJ 80 | SPFJ080.X | 07945879327 | – | • | – |
| SPFJ | 90 | 090. | SPFJ090 | SPFJ 90 | SPFJ090.X | 07945879328 | – | • | – |
| SPFJ | 100 | 100. | SPFJ100 | SPFJ 100 | SPFJ100.X | 07945879329 | – | • | – |
| SPFJ | 125 | 125. | SPFJ125 | SPFJ 125 | SPFJ125.X | 07945894924 | • | • | • |
| SPFJ L | 125 | 125. | SPFJ125L | SPFJ 125 L | SPFJ125.XXL | 07945879546 | – | • | – |
| SPFJ | 160 | 160. | SPFJ160 | SPFJ 160 | SPFJ160.X | 07945894925 | • | • | • |
| SPFJ L | 160 | 160. | SPFJ160L | SPFJ 160 L | SPFJ160.XXL | 07945879547 | – | • | – |
| SPFJ | 200 | 200. | SPFJ200 | SPFJ 200 | SPFJ200.X | 07945894926 | • | • | • |
| SPFJ L | 200 | 200. | SPFJ200L | SPFJ 200 L | SPFJ200.XXL | 07945879548 | – | • | – |
| SPFJ | 250 | 250. | SPFJ250 | SPFJ 250 | SPFJ250.X | 07945894927 | • | • | – |
| SPFJ | 300 | 300. | SPFJ300 | SPFJ 300 | SPFJ300.X | 07945894928 | • | • | – |
| SPFJ | 350 | 350. | SPFJ350 | SPFJ 350 | SPFJ350.X | 07945894929 | • | • | – |
| SPFJ | 400 | 400. | SPFJ400 | SPFJ 400 | SPFJ400.X | 07945894930 | • | • | – |
| SPFJ | 450 | 450. | SPFJ450 | SPFJ 450 | SPFJ450.X | 07945894931 | • | • | – |

Electrical Specifications

| CATALOG NUMBER | VOLTAGE RATING | | INTERRUPTING RATING | | NOM COLD RESISTANCE (OHM) | WATTS LOSS AT 100 % RATED CURRENT (W) | WATTS LOSS AT 80 % RATED CURRENT (W) | WATTS LOSS AT 70 % RATED CURRENT (W) | TOTAL CLEARING I ² T (A ² S) 100 KA (600 V AC) | TOTAL CLEARING I ² T (A ² S) 10 KA (1000 V DC) | TOTAL CLEARING I ² T (A ² S) 20 KA (1000 V DC) |
|----------------|----------------|------|---------------------|-------|---------------------------|---------------------------------------|--------------------------------------|--------------------------------------|--|--|--|
| | AC | DC | AC | DC | | | | | | | |
| SPFJ070 | – | 1000 | – | 20 kA | 1.930 | 12.56 | 7.17 | 5.30 | – | – | 5212.9 |
| SPFJ080 | – | 1000 | – | 20 kA | 1.700 | 15.32 | 8.62 | 6.18 | – | – | 6971.4 |
| SPFJ090 | – | 1000 | – | 20 kA | 1.436 | 14.83 | 8.31 | 6.10 | – | – | 10487.2 |
| SPFJ100 | – | 1000 | – | 20 kA | 1.243 | 18.01 | 9.98 | 7.19 | – | – | 12244 |
| SPFJ125 | 600 | 1000 | 200 kA | 20 kA | 0.964 | 23.00 | 12.60 | 9.04 | 24750 | 17391 | 23529 |
| SPFJ125L | – | 1000 | – | 20 kA | 0.964 | 23.00 | 12.60 | 9.04 | – | 17391 | 23529 |
| SPFJ160 | 600 | 1000 | 200 kA | 20 kA | 0.613 | 22.77 | 12.67 | 9.15 | 60100 | 38771 | 47465 |
| SPFJ160L | – | 1000 | – | 20 kA | 0.613 | 22.77 | 12.67 | 9.15 | – | 38771 | 47465 |
| SPFJ200 | 600 | 1000 | 200 kA | 20 kA | 0.460 | 27.40 | 15.09 | 10.87 | 108000 | 66151 | 79642 |
| SPFJ200L | – | 1000 | – | 20 kA | 0.460 | 27.40 | 15.09 | 10.87 | – | 66151 | 79642 |
| SPFJ250 | 600 | 1000 | 200 kA | 10 kA | 0.485 | 49.17 | 26.20 | 20.59 | 85900 | 55897 | – |
| SPFJ300 | 600 | 1000 | 200 kA | 10 kA | 0.367 | 52.90 | 28.32 | 20.02 | 143000 | 91129 | – |
| SPFJ350 | 600 | 1000 | 200 kA | 10 kA | 0.285 | 54.48 | 29.31 | 20.99 | 232000 | 170863 | – |
| SPFJ400 | 600 | 1000 | 200 kA | 10 kA | 0.236 | 58.40 | 31.47 | 22.21 | 400500 | 287094 | – |
| SPFJ450 | 600 | 1000 | 200 kA | 20 kA | 0.187 | 50.55 | 28.68 | 20.79 | 565333 | 401687 | 400916 |

SPFJ SERIES DC FUSE

Electrical Specification – Agency Requirements

| CATALOG NUMBER | AMPERAGE | OPENING TIME (MINUTES) | | | | | | | | |
|----------------|----------|----------------------------|-----------------------------|----------------------------|-----------------------------|----------------------------|---------|---------|---------|---------|
| | | 100 % OF AMP RATING PER UL | 113 % OF AMP RATING PER IEC | 135 % OF AMP RATING PER UL | 145 % OF AMP RATING PER IEC | 200 % OF AMP RATING PER UL | | | | |
| SPFJ070 | 70 | Temperature Stabilization | — | 120 Max | — | 8 Max | | | | |
| SPFJ080 | 80 | | | | | | | | | |
| SPFJ090 | 90 | | | | | | | | | |
| SPFJ100 | 100 | | | | | | | | | |
| SPFJ125 | 125 | | | | | | 120 Min | 120 Max | 10 Max | |
| SPFJ160 | 160 | | | | | | 180 Min | 180 Max | | 180 Max |
| SPFJ200 | 200 | | | | | | | | | |
| SPFJ250 | 250 | | | | | | | | | |
| SPFJ300 | 300 | | | | | | 240 Min | 240 Max | 240 Max | 14 Max |
| SPFJ350 | 350 | | | | | | | | | |
| SPFJ400 | 400 | | | | | | | | | |
| SPFJ450 | 450 | | | | | | | | | |

Recommended Torque Values for Bus Bar Mounting Fuse

| CATALOG NUMBER | FUSE TORQUE—METRIC (STANDARD) | HARDWARE SIZE—METRIC (STANDARD)* |
|----------------|-------------------------------|----------------------------------|
| SPFJ070 | 7.3 N•m (65 in-lb) | 6mm (1/4 -20) / 8mm (5/16 -18) |
| SPFJ080 | 7.3 N•m (65 in-lb) | 6mm (1/4 -20) / 8mm (5/16 -18) |
| SPFJ090 | 7.3 N•m (65 in-lb) | 6mm (1/4 -20) / 8mm (5/16 -18) |
| SPFJ100 | 7.3 N•m (65 in-lb) | 6mm (1/4 -20) / 8mm (5/16 -18) |
| SPFJ125 | 7.3 N•m (65 in-lb) | 6mm (1/4 -20) [†] |
| SPFJ160 | 7.3 N•m (65 in-lb) | 6mm (1/4 -20) [†] |
| SPFJ200 | 7.3 N•m (65 in-lb) | 6mm (1/4 -20) [†] |
| SPFJ250 | 19.2 N•m (170 in-lb) | 10mm (3/8 -16) |
| SPFJ300 | 19.2 N•m (170 in-lb) | 10mm (3/8 -16) |
| SPFJ350 | 19.2 N•m (170 in-lb) | 10mm (3/8 -16) |
| SPFJ400 | 19.2 N•m (170 in-lb) | 10mm (3/8 -16) |
| SPFJ450 | 19.2 N•m (170 in-lb) | 12mm (7/16 -14) |

* Recommended minimum hardware grade 2 or class 5.8
[†] 8 mm (5/16-18) for SPFJ L dimension option

Temperature Derating Curve (Temperature of Air Immediately Surrounding Fuse)

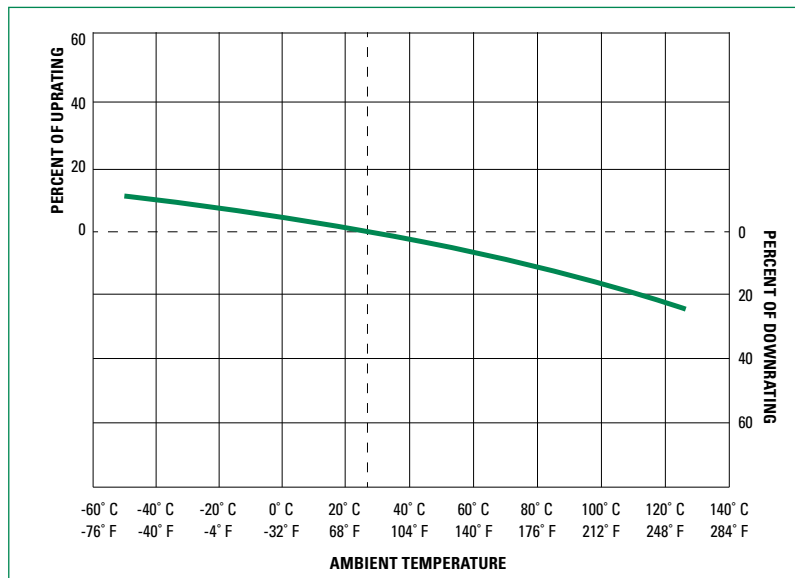

SPFJ SERIES DC FUSE

Time Current Curve

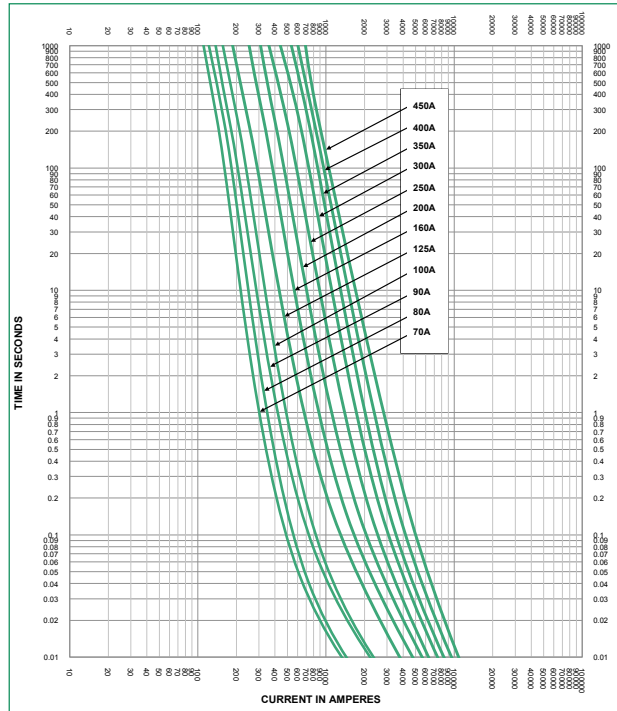

Peak Let-Thru Curve (125–450 A)*

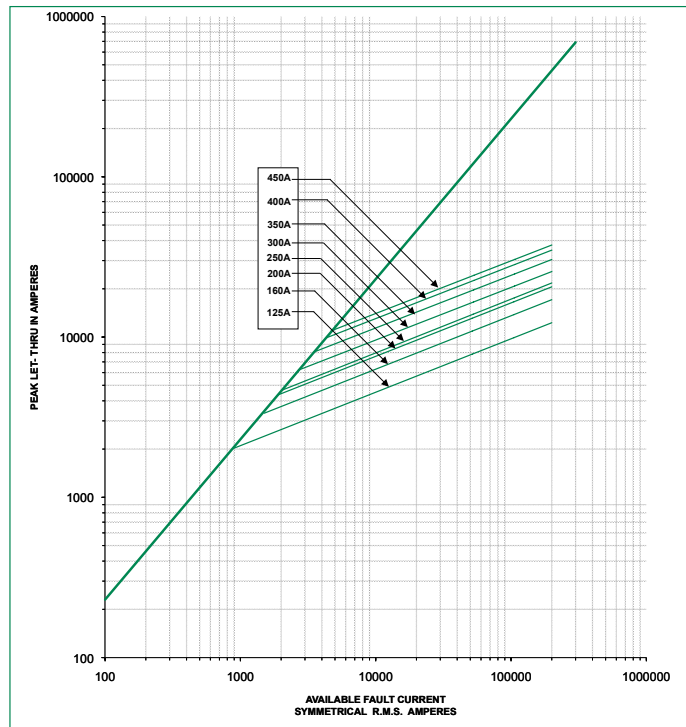

*Tested at 600 V ac

Disclaimer Notice - Information furnished is believed to be accurate and reliable. However, users should independently evaluate the suitability of and test each product selected for their own applications. Littelfuse products are not designed for, and may not be used in, all applications. Read complete Disclaimer Notice at www.littelfuse.com/product-disclaimer.