

# POWR-GARD® Fuses

## L17T Series Telcom Power Fuses

170 V dc • Current-Limiting • 70–1200 A



### Description

The L17T series fuses are specifically designed for short-circuit protection of telecommunication systems. They are extremely current-limiting and offer reliable protection of sensitive DC power distribution systems. Constructed with silver-plated elements for low  $I^2t$  and peak let-through, these advanced fuses eliminate equipment damage due to surges and spikes. The L17T Series fuse's unique element geometry provides cooler running temperatures, helping to minimize heat within enclosures.

### Features & Benefits

FEATURES	BENEFITS
<b>Extremely current-limiting</b>	Reduces damage caused by heating and magnetic effects of short-circuit currents
<b>Low operating temperature</b>	Minimizes heat damage
<b>Low <math>I^2t</math></b>	Better system protection
<b>POWR-GARD® technology</b>	Ensures quality overcurrent protection

### Applications

- Telecommunications DC power distribution systems

### Specifications

<b>Voltage Rating</b>	170 V dc
<b>Ampere Range</b>	70–1200 A
<b>Interrupting Ratings</b>	100 kA
<b>Applicable Standards</b>	UL 248-13

### Certification & Compliance

<b>UL</b>	UL Recognized (File: E71611)
<b>CSA</b>	CSA Certified (File: LR29862)

# POWR-GARD® Fuses

## L17T Series Telcom Power Fuses

### Accessories

LTFD 6001 series fuse holder  
LTFD 1200 series fuse holder

### Ordering Information

SERIES	AMPERE	CATALOG NUMBER	PRODUCT MARKING	PACK QUANTITY	ORDERING NUMBER	UPC	AGENCY APPROVALS	
							UL	CSA
L17T	70	L17T070	L17T 70	10	L17T070.T	07945802756	•	•
L17T	90	L17T090	L17T 90	10	L17T090.T	07945806204	•	•
L17T	100	L17T100	L17T 100	10	L17T100.T	07945802757	•	•
L17T	125	L17T125	L17T 125	10	L17T125.T	07945802927	•	•
L17T	150	L17T150	L17T 150	10	L17T150.T	07945802758	•	•
L17T	175	L17T175	L17T 175	10	L17T175.T	07945806205	•	•
L17T	200	L17T200	L17T 200	10	L17T200.T	07945802760	•	•
L17T	225	L17T225	L17T 225	10	L17T225.T	07945802760	•	•
L17T	250	L17T250	L17T 250	10	L17T250.T	07945802761	•	•
L17T	300	L17T300	L17T 300	5	L17T300.V	07945802762	•	•
L17T	350	L17T350	L17T 350	5	L17T350.V	07945802763	•	•
L17T	400	L17T400	L17T 400	5	L17T400.V	07945802764	•	•
L17T	450	L17T450	L17T 450	5	L17T450.V	07945802765	•	•
L17T	500	L17T500	L17T 500	5	L17T500.V	07945802766	•	•
L17T	600	L17T600	L17T 600	5	L17T600.V	07945802767	•	•
L17T	800	L17T800	L17T 800	5	L17T800.V	07945803180	•	•
L17T	900	L17T900	L17T900	5	L17T900.V	07945806166	•	•
L17T	1000	L17T1000	L17T1000	5	L17T1000V	07945806167	•	•
L17T	1100	L17T1100	L17T1100	5	L17T1100V	07945806168	•	•
L17T	1200	L17T1200	L17T1200	5	L17T1200V	07945806078	•	•

### Dimensions

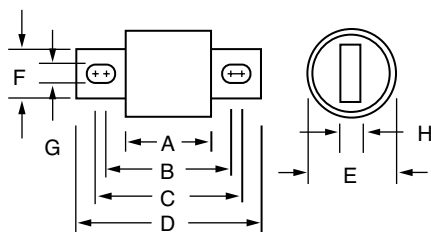

AMPS	DIMENSIONS INCHES (MM)							
	A	B	C	D	E	F	G	H
70–250	1½ (29.4)	1 (47.6)	2⅞ (55.6)	2²¹⁄₃₂ (67.5)	1 (25.4)	⅞ (22.2)	0.327 (8.3)	⅜ (4.8)
300–800	1¼ (31.8)	1⅞ (49.2)	2⅞ (65.1)	3½ (88.9)	1½ (38.1)	1 (25.4)	1⅜ (10.3)	¼ (6.35)
900–1200	1½ (34.0)	—	—	4⅞ (103.1)	—	1½ (38.1)	—	¼ (6.35)

**Disclaimer Notice** – Information furnished is believed to be accurate and reliable. However, users should independently evaluate the suitability of and test each product selected for their own applications. Littelfuse products are not designed for, and may not be used in, all applications. Read complete Disclaimer Notice at [www.littelfuse.com/product-disclaimer](http://www.littelfuse.com/product-disclaimer).