

08096600 & 08097900 BATTERY DISCONNECT SWITCHES

250A • DPST • IP65 • M10 Studs • Electrical remote control



Description

The dual pole remote control current isolating switches are encased in a plastic housing, and are turned on and off with the ignition key or a remote control; with a minimum absorption of current. The dual pole versions where the negative and positive pole can be disconnected at the same time.

Features/Benefits

- 250A continuous current rating
- Waterproof IP65/IPX7

Specifications

Max Operating Voltage:	12V DC 24V DC
Max Continuous Current:	250A
Intermittent Current:	2500A at 3 sec
Operating Temp:	-40 °C to +85 °C
Ingress Protection:	IP65/IPX7
Contacts:	Tin-plated Brass Copper
Terminals:	M10 (brass)

Applications

- Heavy trucks
- Buses
- Construction
- Commercial vehicles
- Marine
- Material Handling

Web Resources

Download technical resources at:
littelfuse.com/ManualBatterySwitches

Mounting Diagram

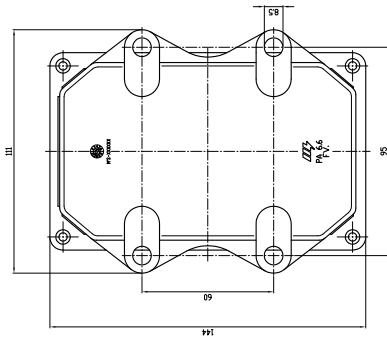

Electrical Diagram

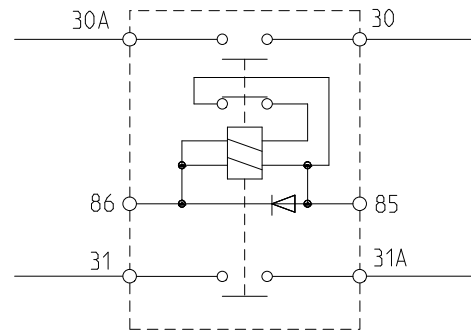

Ordering Information

PART NUMBER	VOLTAGE	AMPERAGE	CIRCUITRY	MOUNTING	INGRESS	TERMINAL NUTS	NOTES
08096600	24V DC	250A	DPST	Bolt-Down	IP65-IPX7	M10 Tin-plated brass	± disconnection separate coil feeding
08097900	12V DC	250A	DPST	Bolt-Down	IP65-IPX7	M10 Tin-plated brass	± disconnection separate coil feeding