



High Current 20EV Fuses

## High Current 20EV Fuse

The HC EV fuse is designed for protection of high-current / high-voltage circuits in electric and hybrid electric vehicles.

### Specifications

Interrupting Rating:	16kA @ 500VDC
Voltage Rating:	500VDC
Operating Temperature Range:	-40°C to +125°C
Net Weight Per Fuse:	35±5 gr
Material:	Body: Melamine (U.L. 94 Flammability rating – V0) Retaining Pins: Stainless Steel Endbells: Zinc Alloy Terminals: Copper Alloy
Mounting Torque:	5-7 Nm M6 (ISO prescription) 10 Nm M6 (Max allowed)
Refers To:	ISO 8820-8 JASO D622

### Ordering Information

Part Number	Termination	Package Size
20EVxxx.ZXBDM	M6 Bolt Down	320

### Time-Current Characteristics

% of Rating	Opening Time Min / Max (s)
110	4 hrs / ∞
200	1.0 / 300
300	0.2 / 30
500	0.05 / 1.0

### Time-Current Characteristic Curves

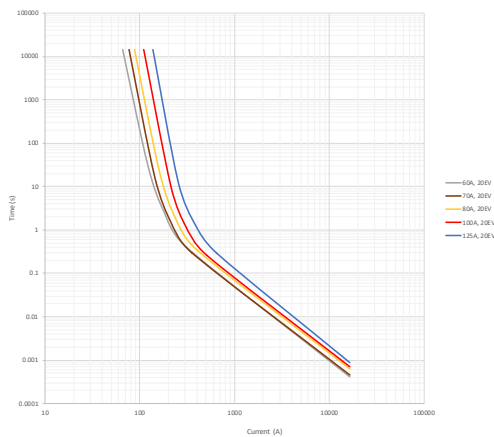

### Ratings

Part Number	Current Rating (A)	Typ. Voltage Drop (mV)	Max. Voltage Drop Spec at 100% IR (mV)	Cold Resistance (mΩ)	Nominal Melting I <sup>2</sup> t (A <sup>2</sup> s)
20EV060.ZXBDM	60 (*)	137	200	1.70	6539
20EV070.ZXBDM	70 (*)	142	200	1.43	8459
20EV080.ZXBDM	80 (*)	145	200	1.25	17836
20EV100.ZXBDM	100 (*)	132	200	0.83	22215
20EV125.ZXBDM	125 (*)	160	200	0.69	33856

(Average Initial Measurements)

(\*) Products in development - please contact Littelfuse® for more details regarding availability timing. Final values for voltage drop, resistance, melting I<sup>2</sup>t and T/C curves will be generated from PV tests data.

### Dimensions

Dimensions in mm

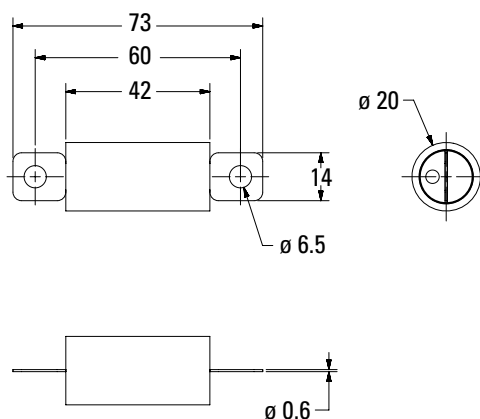

Rev07082021

Littelfuse® products are not designed for, and shall not be used for, any purpose (including, without limitation, automotive, military, aerospace, medical, life-saving, life-sustaining or nuclear facility applications, devices intended for surgical implant into the body, or any other application in which the failure or lack of desired operation of the product may result in personal injury, death, or property damage) other than those expressly set forth in applicable Littelfuse® product documentation. Warranties granted by Littelfuse® shall be deemed void for products used for any purpose not expressly set forth in applicable Littelfuse® documentation. Littelfuse® shall not be liable for any claims or damages arising out of products used in applications not expressly intended by Littelfuse® as set forth in applicable Littelfuse® documentation. The sale and use of Littelfuse® products is subject to Littelfuse Terms and Conditions of Sale, unless otherwise agreed by Littelfuse®.