

NORMALLY-GROUNDED DOOR SWITCHES



9251



91823

Description

On - Momentary Off. Self-grounding in metal panels. Contacts open with plunger depressed, spring return to Ground. 5A at 12V DC (91822 is 3A).

Ordering information

Part No.	Type	Mounting Stem	Terminals	Notes
9251 9251-BX	Single circuit	5/16" -18 self-tapping 1/2" L (12.7mm)	1 female bullet	
9266 9266-BX	Single circuit	3/8" -24 self-tapping 5/16" L (8.0mm)	1 female bullet	5/8" (15.9mm) plunger
91812 91812-BX	Single circuit	7/16" -20 7/16" L (11.1mm)	1 blade	33/64" (13.1mm) plunger
91823 91823-BX	2-circuits	3/8" -24 7/32" L (5.6mm)	2 blades	Both circuits are grounded at same time. 3/16" (4.8mm) plunger, self-adjusting to 1/4" (6.4mm)
<i>91843</i>	<i>2-circuits</i>	<i>3/8" -24 self tapping 0.33" L (8.38mm)</i>	<i>2 blades</i>	<i>0.85" (21.6mm) plunger</i>

Items in italics are available by Special Order only

Part numbers without suffix are supplied bulk; numbers with BX suffix are individually boxed

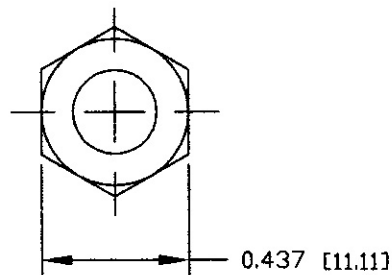

9251 dimensions

