

Installation Instructions

Sealed M10 ZCASE® Fuse



Expertise Applied | Answers Delivered

Part Numbers: 3998600.ZXM10-S, 902-192, and 3998600.ZXM10-SB

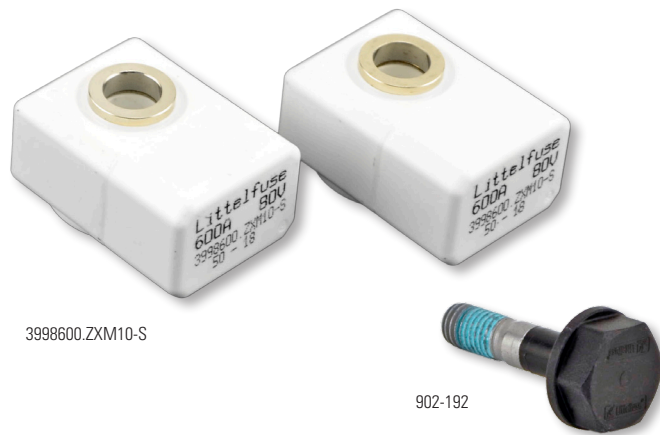

Specifications Overview

Amperage:	600A
Voltage Rating:	80V DC
Fuse Terminal Torque:	18±2Nm
Ingress Protection:	IP67 / IP69K*
Housing:	TPU UL94 V0
Output Connectors:	M10
Special Ratings:	IEC 60079-0 Explosion-Proof*

*Ratings achieved and statements applicable only when used with insulated bolt and a sealed cable lug

Description

The Sealed M10 ZCASE fuse is designed to mount directly to a standard forklift battery to provide short circuit protection to the highest current circuits powering electric vehicles. Its placement on the battery eliminates the need for any unfused, high-current wires off of the battery—even the battery terminal itself is protected from short circuits and accidental contact. In the event of an electrical fault, the ZCASE style fuse performs quickly and effectively, while also eliminating the false blows seen in legacy high speed fuse designs.

Ordering Information

PART NUMBERS	DESCRIPTION
3998600.ZXM10-S	Sealed M10 Battery Mount ZCASE Fuse
3998600.ZXM10-SB	Sealed M10 Battery Mount ZCASE Fuse + Insulated M10 Bolt Kit
902-192	Insulated M10 Bolt (Required for Installation/Operation)

Web Resources

Download datasheet, 2D print, 3D model and more at: littelfuse.com/SealedM10ZCASE

Figure 1 - Front and Side View

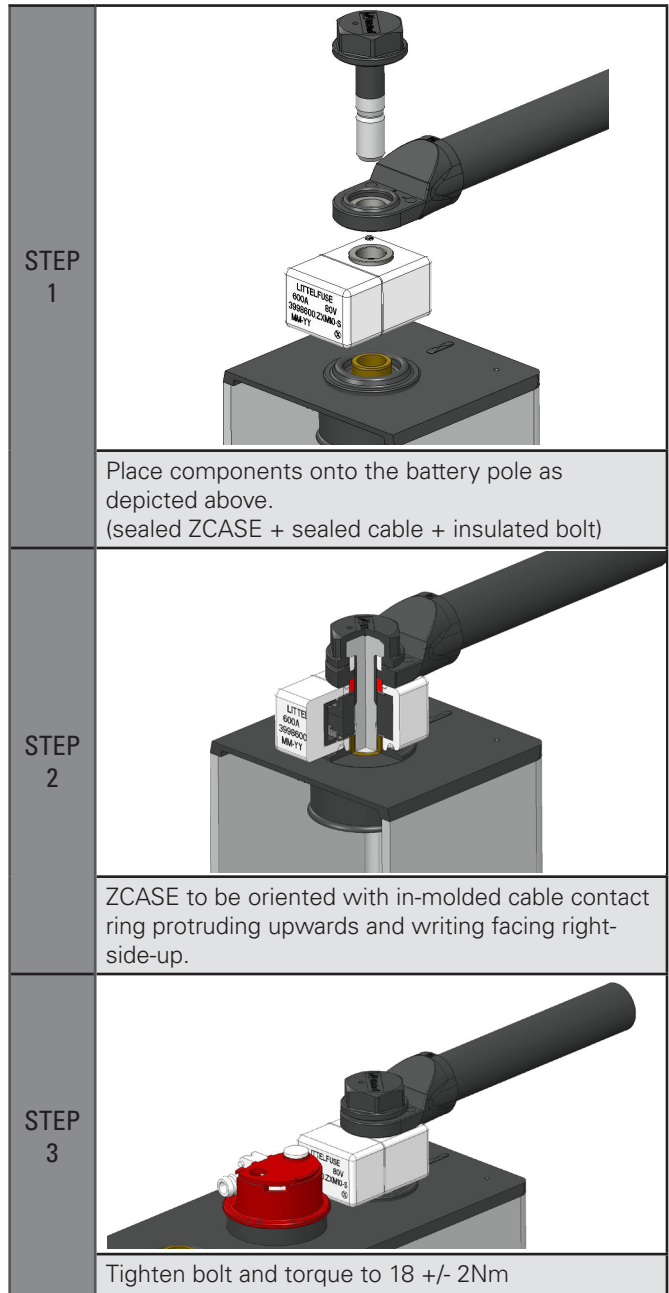

Specifications, descriptions and illustrative material in this literature are as accurate as known at the time of publication, but are subject to changes without notice. Visit littelfuse.com for the most up-to-date technical information.